

DAISY CHAIN PATTERN PAD VIEW

WIRE BONDING PAD DETAIL 1

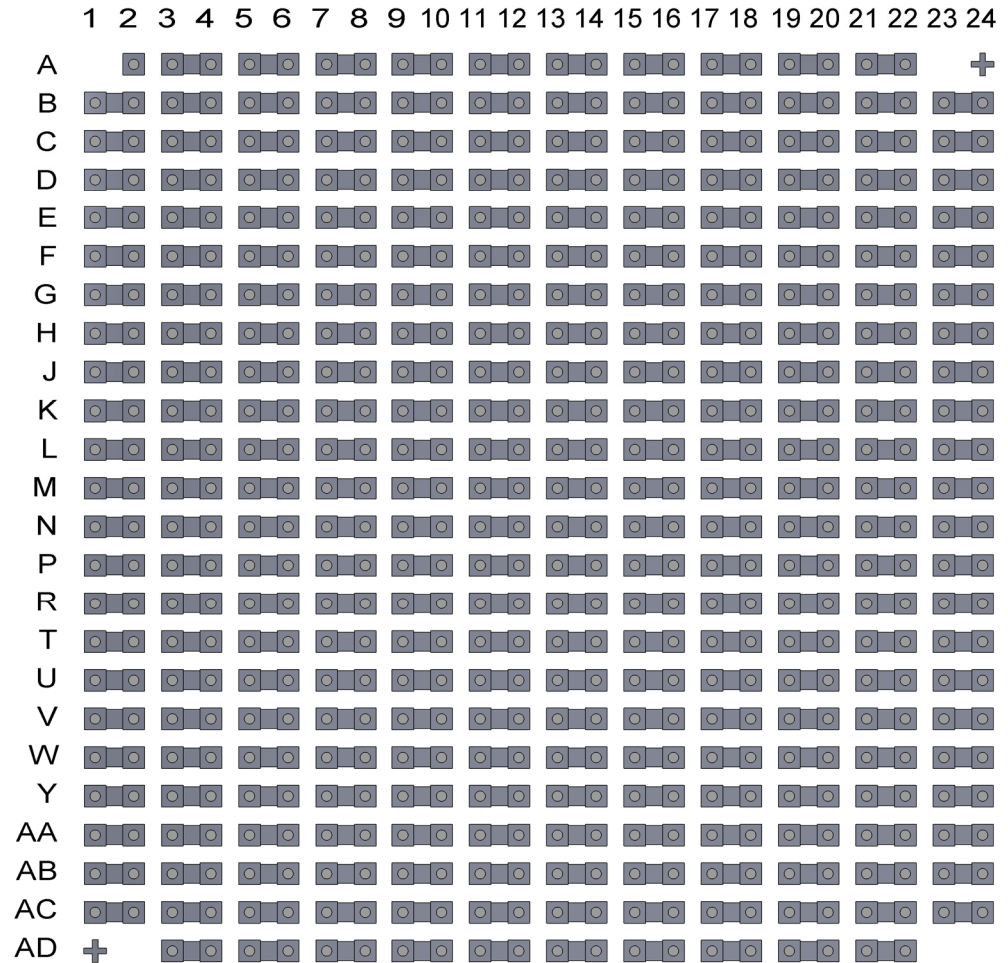
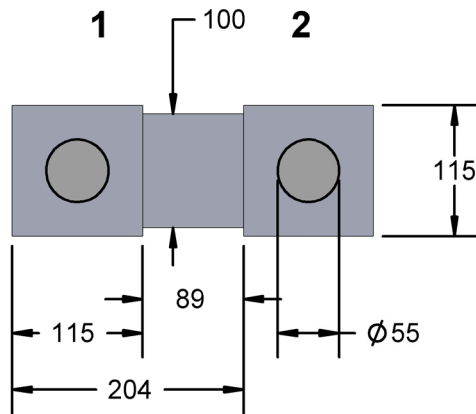

- NOTES:
 1) DIMENSIONS IN MICRONS (µm) OR AS SPECIFIED.
 2) THICKNESS: 635µm (OTHER AVAILABLE).
 3) PASSIVATION: NITRIDE 8KA THICKNESS (0.8µm).
 4) PACKAGING: STANDARD WAFFLE PACK (TRAY).
 5) PAD METAL THICKNESS: 8KA (0.8µm)

| PART NUMBER TABLE | | | | |
|-------------------|----------|---------------|-----------|--------|
| PART NUMBER | DIE SIZE | DIE PER WAFER | BOND SITE | DETAIL |
| FCN569L5A204-DC | 5.08mm | 340 | Ø55 | 1 |

| | | | | | |
|-------------|-----------|---|------|-------------|--------------|
| APPROVALS | DATE | TopLine® | | | |
| DRAWN T.Au | 5/22/2018 | TITLE FCN569 - 204µM PITCH DAISY CHAIN DIE | | | |
| ENG M. Hart | 5/22/2018 | | | | |
| MFG | | SCALE | SIZE | DRAWING NO. | REV |
| QA | | 150:1 | A | 682490 | A |
| CUST | | DO NOT SCALE DRAWING | | | SHEET 1 OF 8 |
| REVISED | | | | | |

OUTLINE DIMENSIONS

BACK SIDE

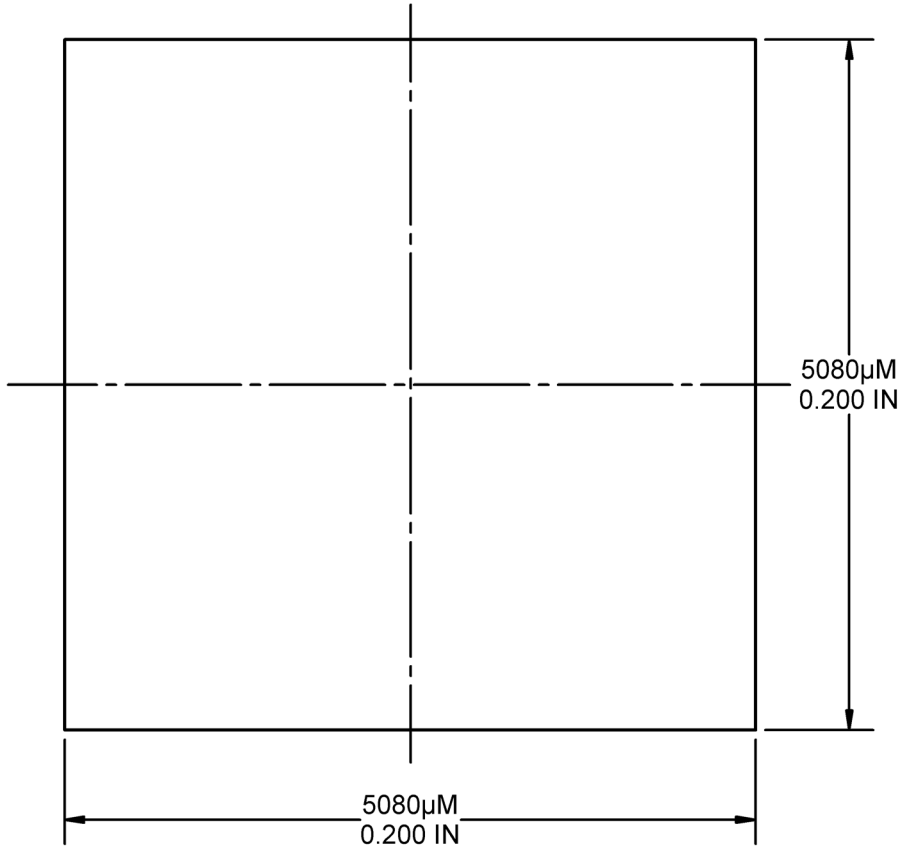

PAD SIDE

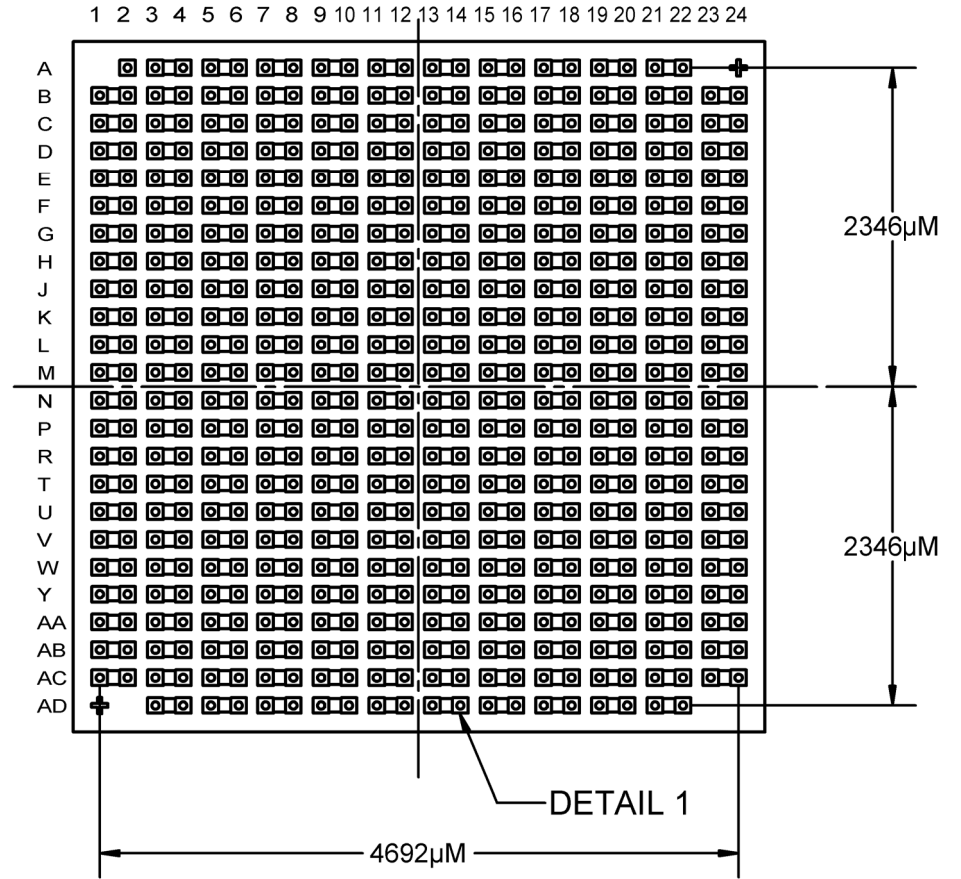

DETAIL 1

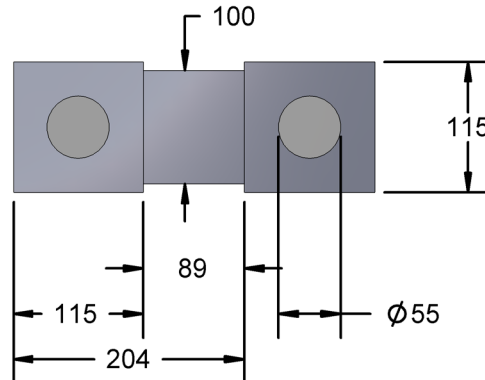

| | | | |
|---|-----------|-----------------------|--------------|
| TopLine | | | |
| TITLE FCN569 - 204µM PITCH DAISY CHAIN DIE | | | |
| SCALE 150:1 | SIZE A | DRAWING NO. 682490 | REV A |
| DO NOT SCALE DRAWING | | | SHEET 2 OF 8 |

PAD LOCATION DIMENSION IN MICRON (μM)

NOTES:

- 1) DIMENSIONS IN MICRON (μM).
- 2) X = 0, Y = 0 IS CENTER OF DIE.
- 3) SEE NET LIST PAGE 5-7.

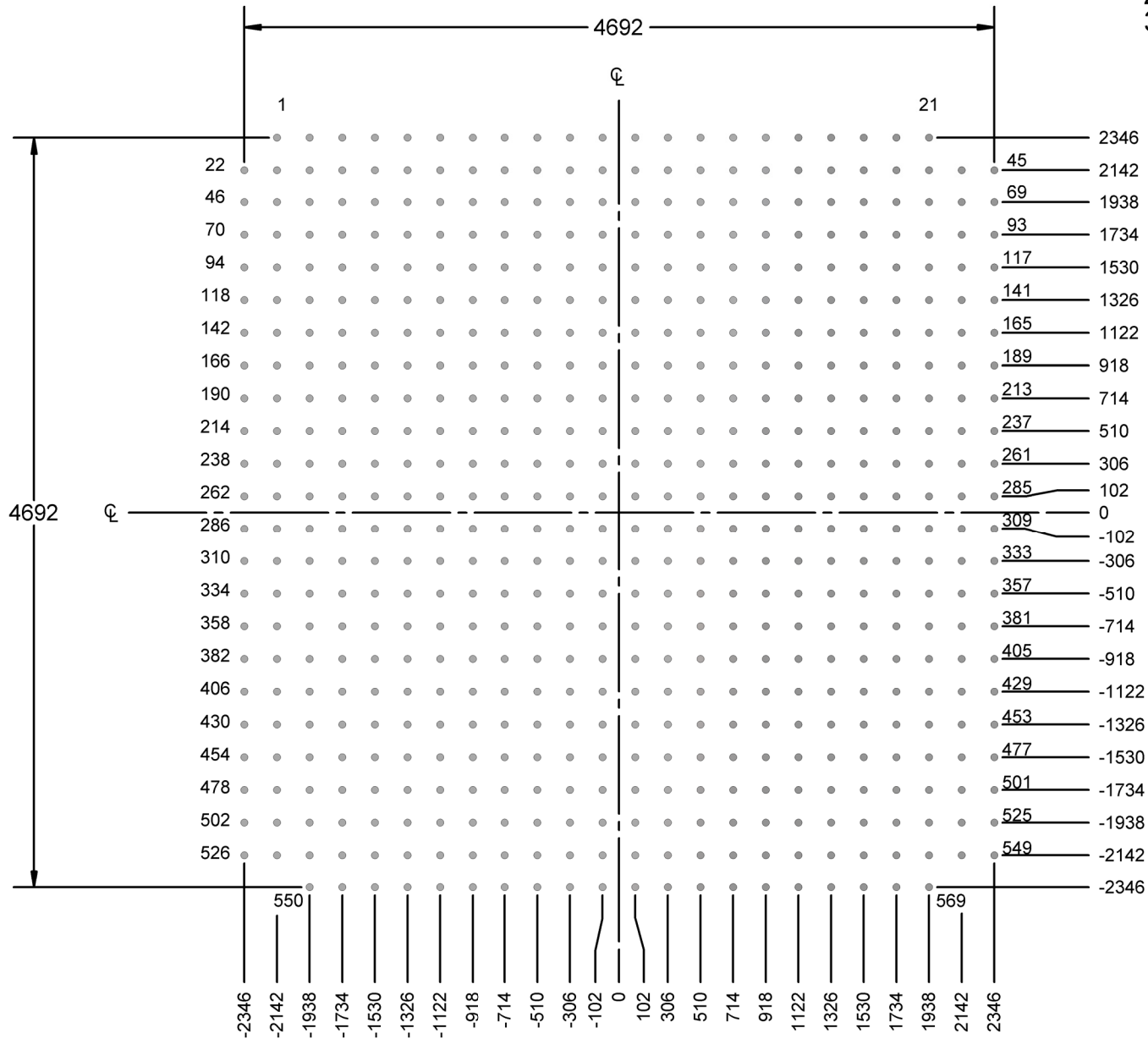

| | | | |
|---|-----------|-----------------------|--------------|
| TopLine | | | |
| TITLE FCN569 - 204 μM PITCH DAISY CHAIN DIE | | | |
| SCALE 30:1 | SIZE A | DRAWING NO. 682490 | REV A |
| DO NOT SCALE DRAWING | | | SHEET 3 OF 8 |

BONDING MAP SEE NET LIST (PAGES 5 TO 7)

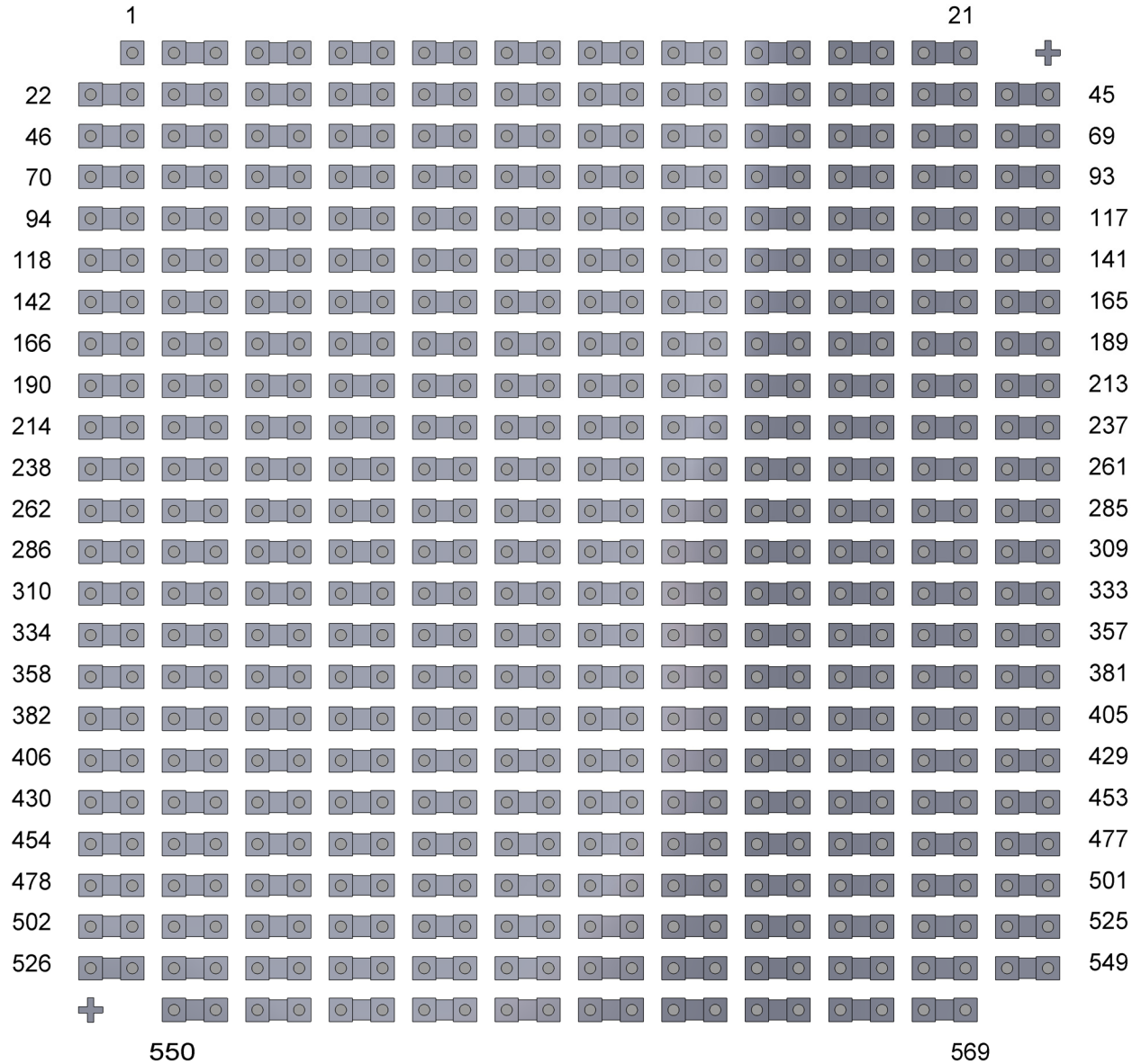

| | | | |
|---|-----------|-----------------------|--------------|
| TopLine® | | | |
| TITLE FCN569 - 204uM PITCH DAISY CHAIN DIE | | | |
| SCALE 30:1 | SIZE A | DRAWING NO. 682490 | REV A |
| DO NOT SCALE DRAWING | | | SHEET 4 OF 8 |

FCN569 NET LIST

| PIN# | X | Y |
|------|-------|------|
| 1 | -2142 | 2346 |
| 2 | -1938 | 2346 |
| 3 | -1734 | 2346 |
| 4 | -1530 | 2346 |
| 5 | -1326 | 2346 |
| 6 | -1122 | 2346 |
| 7 | -918 | 2346 |
| 8 | -714 | 2346 |
| 9 | -510 | 2346 |
| 10 | -306 | 2346 |
| 11 | -102 | 2346 |
| 12 | 102 | 2346 |
| 13 | 306 | 2346 |
| 14 | 510 | 2346 |
| 15 | 714 | 2346 |
| 16 | 918 | 2346 |
| 17 | 1122 | 2346 |
| 18 | 1326 | 2346 |
| 19 | 1530 | 2346 |
| 20 | 1734 | 2346 |
| 21 | 1938 | 2346 |
| 22 | -2346 | 2142 |
| 23 | -2142 | 2142 |
| 24 | -1938 | 2142 |
| 25 | -1734 | 2142 |
| 26 | -1530 | 2142 |
| 27 | -1326 | 2142 |
| 28 | -1122 | 2142 |
| 29 | -918 | 2142 |
| 30 | -714 | 2142 |
| 31 | -510 | 2142 |
| 32 | -306 | 2142 |
| 33 | -102 | 2142 |
| 34 | 102 | 2142 |
| 35 | 306 | 2142 |
| 36 | 510 | 2142 |
| 37 | 714 | 2142 |
| 38 | 918 | 2142 |
| 39 | 1122 | 2142 |
| 40 | 1326 | 2142 |
| 41 | 1530 | 2142 |
| 42 | 1734 | 2142 |
| 43 | 1938 | 2142 |
| 44 | 2142 | 2142 |
| 45 | 2346 | 2142 |
| 46 | -2346 | 1938 |
| 47 | -2142 | 1938 |
| 48 | -1938 | 1938 |
| 49 | -1734 | 1938 |
| 50 | -1530 | 1938 |

| PIN# | X | Y |
|------|-------|------|
| 51 | -1326 | 1938 |
| 52 | -1122 | 1938 |
| 53 | -918 | 1938 |
| 54 | -714 | 1938 |
| 55 | -510 | 1938 |
| 56 | -306 | 1938 |
| 57 | -102 | 1938 |
| 58 | 102 | 1938 |
| 59 | 306 | 1938 |
| 60 | 510 | 1938 |
| 61 | 714 | 1938 |
| 62 | 918 | 1938 |
| 63 | 1122 | 1938 |
| 64 | 1326 | 1938 |
| 65 | 1530 | 1938 |
| 66 | 1734 | 1938 |
| 67 | 1938 | 1938 |
| 68 | 2142 | 1938 |
| 69 | 2346 | 1938 |
| 70 | -2346 | 1734 |
| 71 | -2142 | 1734 |
| 72 | -1938 | 1734 |
| 73 | -1734 | 1734 |
| 74 | -1530 | 1734 |
| 75 | -1326 | 1734 |
| 76 | -1122 | 1734 |
| 77 | -918 | 1734 |
| 78 | -714 | 1734 |
| 79 | -510 | 1734 |
| 80 | -306 | 1734 |
| 81 | -102 | 1734 |
| 82 | 102 | 1734 |
| 83 | 306 | 1734 |
| 84 | 510 | 1734 |
| 85 | 714 | 1734 |
| 86 | 918 | 1734 |
| 87 | 1122 | 1734 |
| 88 | 1326 | 1734 |
| 89 | 1530 | 1734 |
| 90 | 1734 | 1734 |
| 91 | 1938 | 1734 |
| 92 | 2142 | 1734 |
| 93 | 2346 | 1734 |
| 94 | -2346 | 1530 |
| 95 | -2142 | 1530 |
| 96 | -1938 | 1530 |
| 97 | -1734 | 1530 |
| 98 | -1530 | 1530 |
| 99 | -1326 | 1530 |
| 100 | -1122 | 1530 |

| PIN# | X | Y |
|------|-------|------|
| 101 | -918 | 1530 |
| 102 | -714 | 1530 |
| 103 | -510 | 1530 |
| 104 | -306 | 1530 |
| 105 | -102 | 1530 |
| 106 | 102 | 1530 |
| 107 | 306 | 1530 |
| 108 | 510 | 1530 |
| 109 | 714 | 1530 |
| 110 | 918 | 1530 |
| 111 | 1122 | 1530 |
| 112 | 1326 | 1530 |
| 113 | 1530 | 1530 |
| 114 | 1734 | 1530 |
| 115 | 1938 | 1530 |
| 116 | 2142 | 1530 |
| 117 | 2346 | 1530 |
| 118 | -2346 | 1326 |
| 119 | -2142 | 1326 |
| 120 | -1938 | 1326 |
| 121 | -1734 | 1326 |
| 122 | -1530 | 1326 |
| 123 | -1326 | 1326 |
| 124 | -1122 | 1326 |
| 125 | -918 | 1326 |
| 126 | -714 | 1326 |
| 127 | -510 | 1326 |
| 128 | -306 | 1326 |
| 129 | -102 | 1326 |
| 130 | 102 | 1326 |
| 131 | 306 | 1326 |
| 132 | 510 | 1326 |
| 133 | 714 | 1326 |
| 134 | 918 | 1326 |
| 135 | 1122 | 1326 |
| 136 | 1326 | 1326 |
| 137 | 1530 | 1326 |
| 138 | 1734 | 1326 |
| 139 | 1938 | 1326 |
| 140 | 2142 | 1326 |
| 141 | 2346 | 1326 |
| 142 | -2346 | 1122 |
| 143 | -2142 | 1122 |
| 144 | -1938 | 1122 |
| 145 | -1734 | 1122 |
| 146 | -1530 | 1122 |
| 147 | -1326 | 1122 |
| 148 | -1122 | 1122 |
| 149 | -918 | 1122 |
| 150 | -714 | 1122 |

| PIN# | X | Y |
|------|-------|------|
| 151 | -510 | 1122 |
| 152 | -306 | 1122 |
| 153 | -102 | 1122 |
| 154 | 102 | 1122 |
| 155 | 306 | 1122 |
| 156 | 510 | 1122 |
| 157 | 714 | 1122 |
| 158 | 918 | 1122 |
| 159 | 1122 | 1122 |
| 160 | 1326 | 1122 |
| 161 | 1530 | 1122 |
| 162 | 1734 | 1122 |
| 163 | 1938 | 1122 |
| 164 | 2142 | 1122 |
| 165 | 2346 | 1122 |
| 166 | -2346 | 918 |
| 167 | -2142 | 918 |
| 168 | -1938 | 918 |
| 169 | -1734 | 918 |
| 170 | -1530 | 918 |
| 171 | -1326 | 918 |
| 172 | -1122 | 918 |
| 173 | -918 | 918 |
| 174 | -714 | 918 |
| 175 | -510 | 918 |
| 176 | -306 | 918 |
| 177 | -102 | 918 |
| 178 | 102 | 918 |
| 179 | 306 | 918 |
| 180 | 510 | 918 |
| 181 | 714 | 918 |
| 182 | 918 | 918 |
| 183 | 1122 | 918 |
| 184 | 1326 | 918 |
| 185 | 1530 | 918 |
| 186 | 1734 | 918 |
| 187 | 1938 | 918 |
| 188 | 2142 | 918 |
| 189 | 2346 | 918 |
| 190 | -2346 | 714 |
| 191 | -2142 | 714 |
| 192 | -1938 | 714 |
| 193 | -1734 | 714 |
| 194 | -1530 | 714 |
| 195 | -1326 | 714 |
| 196 | -1122 | 714 |
| 197 | -918 | 714 |
| 198 | -714 | 714 |
| 199 | -510 | 714 |
| 200 | -306 | 714 |

CONTINUE ON PAGE 6

NOTES:

- 1) DIMENSIONS IN MICRON (μM).
- 2) X = 0, Y = 0 IS CENTER OF DIE.



| | | | |
|---|------|-------------|--------------|
| TITLE | | | |
| FCN569 - 204 μM PITCH DAISY CHAIN DIE | | | |
| SCALE | SIZE | DRAWING NO. | REV |
| NONE | A | 682490 | A |
| DO NOT SCALE DRAWING | | | SHEET 5 OF 8 |

FCN569 NET LIST

| PIN# | X | Y |
|------|-------|-----|
| 201 | -102 | 714 |
| 202 | 102 | 714 |
| 203 | 306 | 714 |
| 204 | 510 | 714 |
| 205 | 714 | 714 |
| 206 | 918 | 714 |
| 207 | 1122 | 714 |
| 208 | 1326 | 714 |
| 209 | 1530 | 714 |
| 210 | 1734 | 714 |
| 211 | 1938 | 714 |
| 212 | 2142 | 714 |
| 213 | 2346 | 714 |
| 214 | -2346 | 510 |
| 215 | -2142 | 510 |
| 216 | -1938 | 510 |
| 217 | -1734 | 510 |
| 218 | -1530 | 510 |
| 219 | -1326 | 510 |
| 220 | -1122 | 510 |
| 221 | -918 | 510 |
| 222 | -714 | 510 |
| 223 | -510 | 510 |
| 224 | -306 | 510 |
| 225 | -102 | 510 |
| 226 | 102 | 510 |
| 227 | 306 | 510 |
| 228 | 510 | 510 |
| 229 | 714 | 510 |
| 230 | 918 | 510 |
| 231 | 1122 | 510 |
| 232 | 1326 | 510 |
| 233 | 1530 | 510 |
| 234 | 1734 | 510 |
| 235 | 1938 | 510 |
| 236 | 2142 | 510 |
| 237 | 2346 | 510 |
| 238 | -2346 | 306 |
| 239 | -2142 | 306 |
| 240 | -1938 | 306 |
| 241 | -1734 | 306 |
| 242 | -1530 | 306 |
| 243 | -1326 | 306 |
| 244 | -1122 | 306 |
| 245 | -918 | 306 |
| 246 | -714 | 306 |
| 247 | -510 | 306 |
| 248 | -306 | 306 |
| 249 | -102 | 306 |
| 250 | 102 | 306 |

| PIN# | X | Y |
|------|-------|------|
| 251 | 306 | 306 |
| 252 | 510 | 306 |
| 253 | 714 | 306 |
| 254 | 918 | 306 |
| 255 | 1122 | 306 |
| 256 | 1326 | 306 |
| 257 | 1530 | 306 |
| 258 | 1734 | 306 |
| 259 | 1938 | 306 |
| 260 | 2142 | 306 |
| 261 | 2346 | 306 |
| 262 | -2346 | 102 |
| 263 | -2142 | 102 |
| 264 | -1938 | 102 |
| 265 | -1734 | 102 |
| 266 | -1530 | 102 |
| 267 | -1326 | 102 |
| 268 | -1122 | 102 |
| 269 | -918 | 102 |
| 270 | -714 | 102 |
| 271 | -510 | 102 |
| 272 | -306 | 102 |
| 273 | -102 | 102 |
| 274 | 102 | 102 |
| 275 | 306 | 102 |
| 276 | 510 | 102 |
| 277 | 714 | 102 |
| 278 | 918 | 102 |
| 279 | 1122 | 102 |
| 280 | 1326 | 102 |
| 281 | 1530 | 102 |
| 282 | 1734 | 102 |
| 283 | 1938 | 102 |
| 284 | 2142 | 102 |
| 285 | 2346 | 102 |
| 286 | -2346 | -102 |
| 287 | -2142 | -102 |
| 288 | -1938 | -102 |
| 289 | -1734 | -102 |
| 290 | -1530 | -102 |
| 291 | -1326 | -102 |
| 292 | -1122 | -102 |
| 293 | -918 | -102 |
| 294 | -714 | -102 |
| 295 | -510 | -102 |
| 296 | -306 | -102 |
| 297 | -102 | -102 |
| 298 | 102 | -102 |
| 299 | 306 | -102 |
| 300 | 510 | -102 |

| PIN# | X | Y |
|------|-------|------|
| 301 | 714 | -102 |
| 302 | 918 | -102 |
| 303 | 1122 | -102 |
| 304 | 1326 | -102 |
| 305 | 1530 | -102 |
| 306 | 1734 | -102 |
| 307 | 1938 | -102 |
| 308 | 2142 | -102 |
| 309 | 2346 | -102 |
| 310 | -2346 | -306 |
| 311 | -2142 | -306 |
| 312 | -1938 | -306 |
| 313 | -1734 | -306 |
| 314 | -1530 | -306 |
| 315 | -1326 | -306 |
| 316 | -1122 | -306 |
| 317 | -918 | -306 |
| 318 | -714 | -306 |
| 319 | -510 | -306 |
| 320 | -306 | -306 |
| 321 | -102 | -306 |
| 322 | 102 | -306 |
| 323 | 306 | -306 |
| 324 | 510 | -306 |
| 325 | 714 | -306 |
| 326 | 918 | -306 |
| 327 | 1122 | -306 |
| 328 | 1326 | -306 |
| 329 | 1530 | -306 |
| 330 | 1734 | -306 |
| 331 | 1938 | -306 |
| 332 | 2142 | -306 |
| 333 | 2346 | -306 |
| 334 | -2346 | -510 |
| 335 | -2142 | -510 |
| 336 | -1938 | -510 |
| 337 | -1734 | -510 |
| 338 | -1530 | -510 |
| 339 | -1326 | -510 |
| 340 | -1122 | -510 |
| 341 | -918 | -510 |
| 342 | -714 | -510 |
| 343 | -510 | -510 |
| 344 | -306 | -510 |
| 345 | -102 | -510 |
| 346 | 102 | -510 |
| 347 | 306 | -510 |
| 348 | 510 | -510 |
| 349 | 714 | -510 |
| 350 | 918 | -510 |

| PIN# | X | Y |
|------|-------|------|
| 351 | 1122 | -510 |
| 352 | 1326 | -510 |
| 353 | 1530 | -510 |
| 354 | 1734 | -510 |
| 355 | 1938 | -510 |
| 356 | 2142 | -510 |
| 357 | 2346 | -510 |
| 358 | -2346 | -714 |
| 359 | -2142 | -714 |
| 360 | -1938 | -714 |
| 361 | -1734 | -714 |
| 362 | -1530 | -714 |
| 363 | -1326 | -714 |
| 364 | -1122 | -714 |
| 365 | -918 | -714 |
| 366 | -714 | -714 |
| 367 | -510 | -714 |
| 368 | -306 | -714 |
| 369 | -102 | -714 |
| 370 | 102 | -714 |
| 371 | 306 | -714 |
| 372 | 510 | -714 |
| 373 | 714 | -714 |
| 374 | 918 | -714 |
| 375 | 1122 | -714 |
| 376 | 1326 | -714 |
| 377 | 1530 | -714 |
| 378 | 1734 | -714 |
| 379 | 1938 | -714 |
| 380 | 2142 | -714 |
| 381 | 2346 | -714 |
| 382 | -2346 | -918 |
| 383 | -2142 | -918 |
| 384 | -1938 | -918 |
| 385 | -1734 | -918 |
| 386 | -1530 | -918 |
| 387 | -1326 | -918 |
| 388 | -1122 | -918 |
| 389 | -918 | -918 |
| 390 | -714 | -918 |
| 391 | -510 | -918 |
| 392 | -306 | -918 |
| 393 | -102 | -918 |
| 394 | 102 | -918 |
| 395 | 306 | -918 |
| 396 | 510 | -918 |
| 397 | 714 | -918 |
| 398 | 918 | -918 |
| 399 | 1122 | -918 |
| 400 | 1326 | -918 |

CONTINUE ON PAGE 7

NOTES:

- 1) DIMENSIONS IN MICRON (μM).
- 2) X = 0, Y = 0 IS CENTER OF DIE.



TITLE FCN569 - 204 μM PITCH
DAISY CHAIN DIE

| | | | |
|---------------|-----------|-----------------------|----------|
| SCALE NONE | SIZE A | DRAWING NO. 682490 | REV A |
|---------------|-----------|-----------------------|----------|

DO NOT SCALE DRAWING

SHEET 6 OF 8

FCN569 NET LIST

| PIN# | X | Y |
|------|-------|-------|
| 401 | 1530 | -918 |
| 402 | 1734 | -918 |
| 403 | 1938 | -918 |
| 404 | 2142 | -918 |
| 405 | 2346 | -918 |
| 406 | -2346 | -1122 |
| 407 | -2142 | -1122 |
| 408 | -1938 | -1122 |
| 409 | -1734 | -1122 |
| 410 | -1530 | -1122 |
| 411 | -1326 | -1122 |
| 412 | -1122 | -1122 |
| 413 | -918 | -1122 |
| 414 | -714 | -1122 |
| 415 | -510 | -1122 |
| 416 | -306 | -1122 |
| 417 | -102 | -1122 |
| 418 | 102 | -1122 |
| 419 | 306 | -1122 |
| 420 | 510 | -1122 |
| 421 | 714 | -1122 |
| 422 | 918 | -1122 |
| 423 | 1122 | -1122 |
| 424 | 1326 | -1122 |
| 425 | 1530 | -1122 |
| 426 | 1734 | -1122 |
| 427 | 1938 | -1122 |
| 428 | 2142 | -1122 |
| 429 | 2346 | -1122 |
| 430 | -2346 | -1326 |
| 431 | -2142 | -1326 |
| 432 | -1938 | -1326 |
| 433 | -1734 | -1326 |
| 434 | -1530 | -1326 |
| 435 | -1326 | -1326 |
| 436 | -1122 | -1326 |
| 437 | -918 | -1326 |
| 438 | -714 | -1326 |
| 439 | -510 | -1326 |
| 440 | -306 | -1326 |
| 441 | -102 | -1326 |
| 442 | 102 | -1326 |
| 443 | 306 | -1326 |
| 444 | 510 | -1326 |
| 445 | 714 | -1326 |
| 446 | 918 | -1326 |
| 447 | 1122 | -1326 |
| 448 | 1326 | -1326 |
| 449 | 1530 | -1326 |
| 450 | 1734 | -1326 |

| PIN# | X | Y |
|------|-------|-------|
| 451 | 1938 | -1326 |
| 452 | 2142 | -1326 |
| 453 | 2346 | -1326 |
| 454 | -2346 | -1530 |
| 455 | -2142 | -1530 |
| 456 | -1938 | -1530 |
| 457 | -1734 | -1530 |
| 458 | -1530 | -1530 |
| 459 | -1326 | -1530 |
| 460 | -1122 | -1530 |
| 461 | -918 | -1530 |
| 462 | -714 | -1530 |
| 463 | -510 | -1530 |
| 464 | -306 | -1530 |
| 465 | -102 | -1530 |
| 466 | 102 | -1530 |
| 467 | 306 | -1530 |
| 468 | 510 | -1530 |
| 469 | 714 | -1530 |
| 470 | 918 | -1530 |
| 471 | 1122 | -1530 |
| 472 | 1326 | -1530 |
| 473 | 1530 | -1530 |
| 474 | 1734 | -1530 |
| 475 | 1938 | -1530 |
| 476 | 2142 | -1530 |
| 477 | 2346 | -1530 |
| 478 | -2346 | -1734 |
| 479 | -2142 | -1734 |
| 480 | -1938 | -1734 |
| 481 | -1734 | -1734 |
| 482 | -1530 | -1734 |
| 483 | -1326 | -1734 |
| 484 | -1122 | -1734 |
| 485 | -918 | -1734 |
| 486 | -714 | -1734 |
| 487 | -510 | -1734 |
| 488 | -306 | -1734 |
| 489 | -102 | -1734 |
| 490 | 102 | -1734 |
| 491 | 306 | -1734 |
| 492 | 510 | -1734 |
| 493 | 714 | -1734 |
| 494 | 918 | -1734 |
| 495 | 1122 | -1734 |
| 496 | 1326 | -1734 |
| 497 | 1530 | -1734 |
| 498 | 1734 | -1734 |
| 499 | 1938 | -1734 |
| 500 | 2142 | -1734 |

| PIN# | X | Y |
|------|-------|-------|
| 501 | 2346 | -1734 |
| 502 | -2346 | -1938 |
| 503 | -2142 | -1938 |
| 504 | -1938 | -1938 |
| 505 | -1734 | -1938 |
| 506 | -1530 | -1938 |
| 507 | -1326 | -1938 |
| 508 | -1122 | -1938 |
| 509 | -918 | -1938 |
| 510 | -714 | -1938 |
| 511 | -510 | -1938 |
| 512 | -306 | -1938 |
| 513 | -102 | -1938 |
| 514 | 102 | -1938 |
| 515 | 306 | -1938 |
| 516 | 510 | -1938 |
| 517 | 714 | -1938 |
| 518 | 918 | -1938 |
| 519 | 1122 | -1938 |
| 520 | 1326 | -1938 |
| 521 | 1530 | -1938 |
| 522 | 1734 | -1938 |
| 523 | 1938 | -1938 |
| 524 | 2142 | -1938 |
| 525 | 2346 | -1938 |
| 526 | -2346 | -2142 |
| 527 | -2142 | -2142 |
| 528 | -1938 | -2142 |
| 529 | -1734 | -2142 |
| 530 | -1530 | -2142 |
| 531 | -1326 | -2142 |
| 532 | -1122 | -2142 |
| 533 | -918 | -2142 |
| 534 | -714 | -2142 |
| 535 | -510 | -2142 |
| 536 | -306 | -2142 |
| 537 | -102 | -2142 |
| 538 | 102 | -2142 |
| 539 | 306 | -2142 |
| 540 | 510 | -2142 |
| 541 | 714 | -2142 |
| 542 | 918 | -2142 |
| 543 | 1122 | -2142 |
| 544 | 1326 | -2142 |
| 545 | 1530 | -2142 |
| 546 | 1734 | -2142 |
| 547 | 1938 | -2142 |
| 548 | 2142 | -2142 |
| 549 | 2346 | -2142 |
| 550 | -1938 | -2346 |

| PIN# | X | Y |
|------|-------|-------|
| 551 | -1734 | -2346 |
| 552 | -1530 | -2346 |
| 553 | -1326 | -2346 |
| 554 | -1122 | -2346 |
| 555 | -918 | -2346 |
| 556 | -714 | -2346 |
| 557 | -510 | -2346 |
| 558 | -306 | -2346 |
| 559 | -102 | -2346 |
| 560 | 102 | -2346 |
| 561 | 306 | -2346 |
| 562 | 510 | -2346 |
| 563 | 714 | -2346 |
| 564 | 918 | -2346 |
| 565 | 1122 | -2346 |
| 566 | 1326 | -2346 |
| 567 | 1530 | -2346 |
| 568 | 1734 | -2346 |
| 569 | 1938 | -2346 |

NOTES:

- 1) DIMENSIONS IN MICRON (μM).
- 2) X = 0, Y = 0 IS CENTER OF DIE.

| | | | |
|---|-----------|-----------------------|--------------|
| TopLine® | | | |
| TITLE FCN569 - 204 μM PITCH DAISY CHAIN DIE | | | |
| SCALE NONE | SIZE A | DRAWING NO. 682490 | REV A |
| DO NOT SCALE DRAWING | | | SHEET 7 OF 8 |

PART NUMBERING SYSTEM

FCN

569

L

5

A

204

- OPTION

- DC

- OPTION

FLIP CHIP

FCN = BUMPLESS CHIP
 FCWN = UNSAWN WAFER
 5" (125mm)

NBR BOND PADS

| PADS | ARRAY | SIZE |
|------|-------|------|
| 569 | 1X | 5MM |
| 2276 | 4X | 10MM |
| 5121 | 9X | 15MM |
| 9104 | 16X | 20MM |

BUMP DIAMETER

DIAM ϕ 89 μ M
 HEIGHT 95 μ M

DIE SIZE

| CODE | MM | MIL |
|------|-------|-----|
| 5 | 5.08 | 200 |
| 10 | 10.16 | 400 |
| 15 | 15.24 | 600 |
| 20 | 20.32 | 800 |

PAD MATERIAL

A = Al98, Si1.0 Cu1.0

PITCH

μ M

OPTIONS

| DIE THINNING | | |
|--------------|-------------|-------|
| CODE | μ M | INCH |
| NONE | 635 μ M | .025" |
| BG530 | 530 μ M | .021" |
| BG430 | 430 μ M | .017" |
| BG360 | 360 μ M | .014" |
| BG250 | 250 μ M | .010" |
| BG200 | 200 μ M | .008" |
| BG150 | 150 μ M | .006" |
| BG100 | 100 μ M | .004" |

OTHER THICKNESS AVAILABLE

DAISY CHAIN

PACKAGING

BLANK = TRAY (STANDARD)

| SIZE | TRAY | QTY |
|------|--------|--------|
| 5MM | 2-INCH | 36 PCS |
| 10MM | 4-INCH | 49 PCS |
| 15MM | 4-INCH | 25 PCS |
| 20MM | 4-INCH | 9 PCS |



| | | | |
|---|-----------|-----------------------|----------|
| TITLE FCN569 - 204 μ M PITCH DAISY CHAIN DIE | | | |
| SCALE 10:1 | SIZE A | DRAWING NO. 682490 | REV A |
| DO NOT SCALE DRAWING | | SHEET 8 OF 8 | |