

CBGA WITH DIE

TOP VIEW

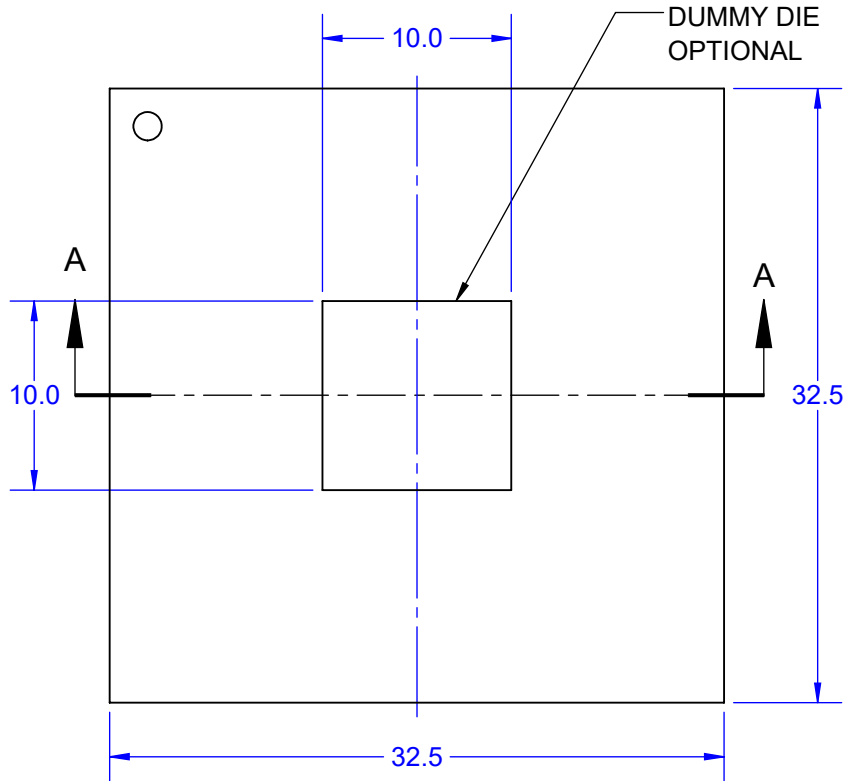

BALL VIEW

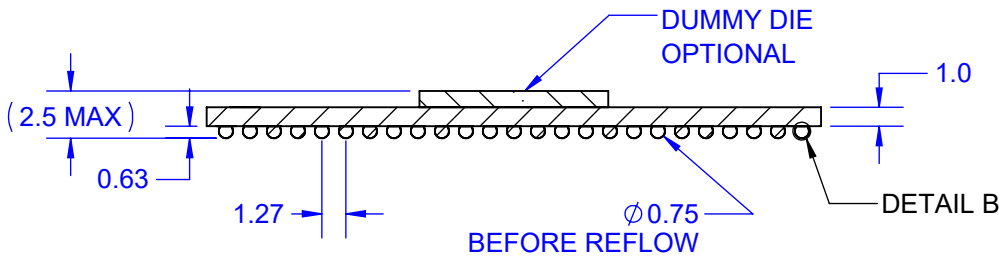
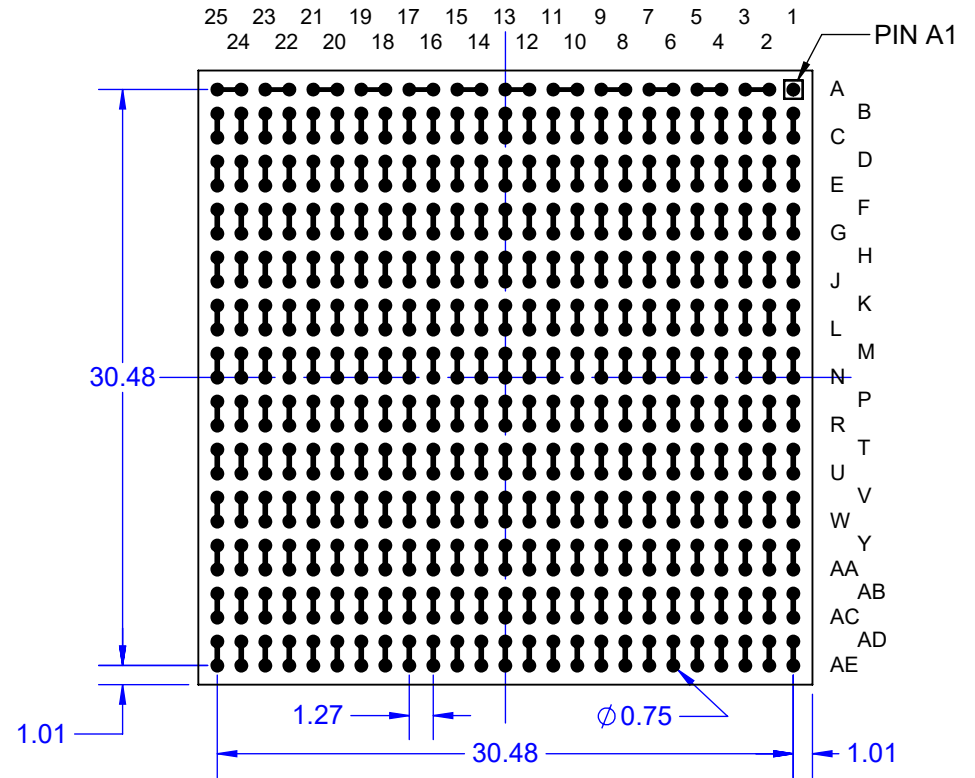

SECTION A-A
SCALE 2.5 : 1

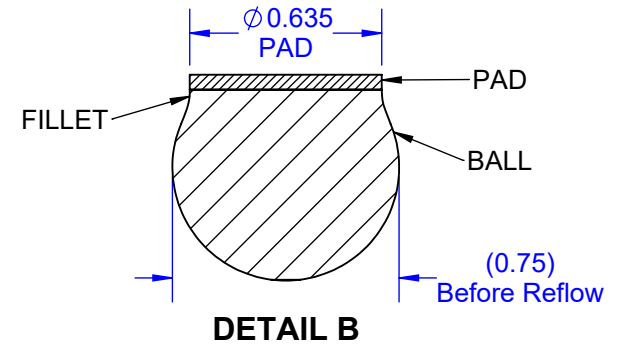

DETAIL B

Notes: (Unless Otherwise Specified).

- 1) ALL DIMENSIONS ARE MM.
- 2) SOLDER BALL ALLOY: SEE PART NUMBER CONFIGURATION.
- 3) BALL DIAMETER (BEFORE REFLOW): 0.76mm (30 MIL).
- 4) SOLDER MASK OPENING: 0.635mm (25 MIL).
- 5) SUBSTRATE: ALUMINA CERAMIC.

APPROVALS		DATE				
DRAWN	T. Au	08/08/2022				
ENG	M. Hart	08/08/2022	TITLE CBGA625T1.27C-DC81 CERAMIC BALL GRID ARRAY			
MFG						
QA			SCALE	SIZE	DRAWING NO.	REV
CUST			2.5:1	A	520817	A
REVISED			DO NOT SCALE DRAWING			SHEET 1 OF 6

TOP VIEW

CBGA WITHOUT DIE

BALL VIEW

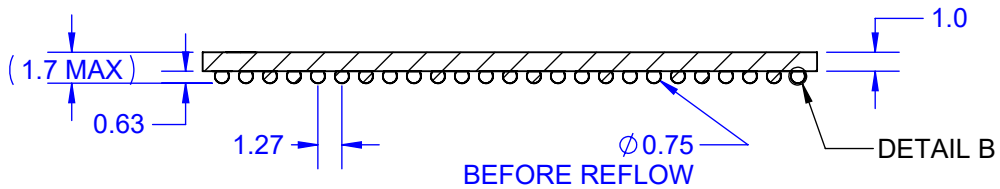
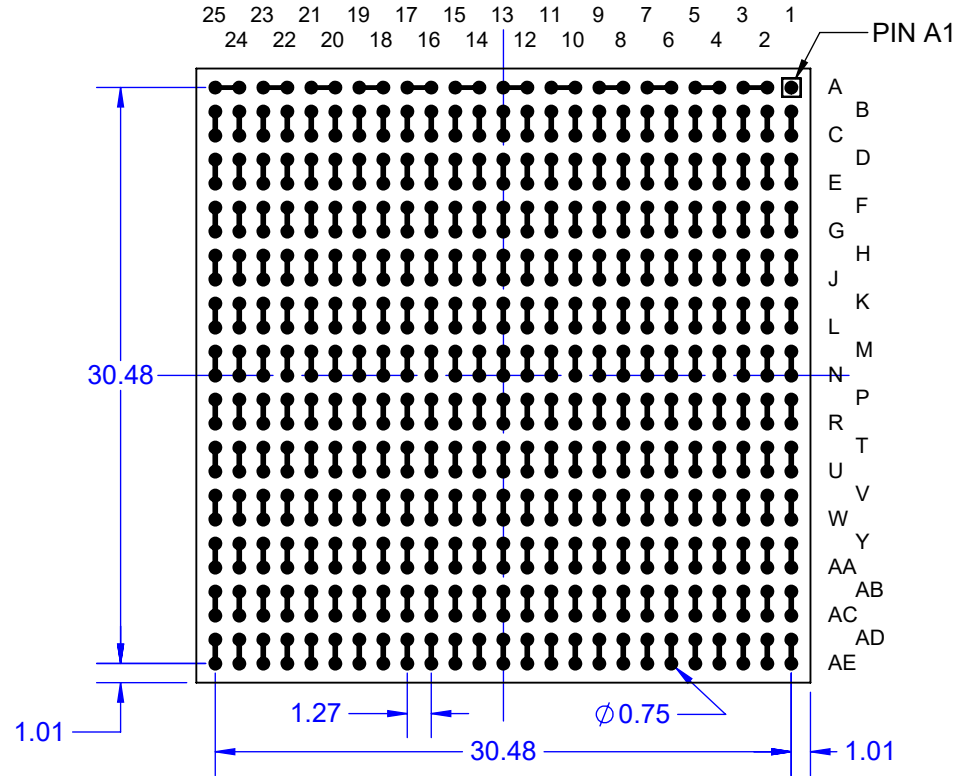
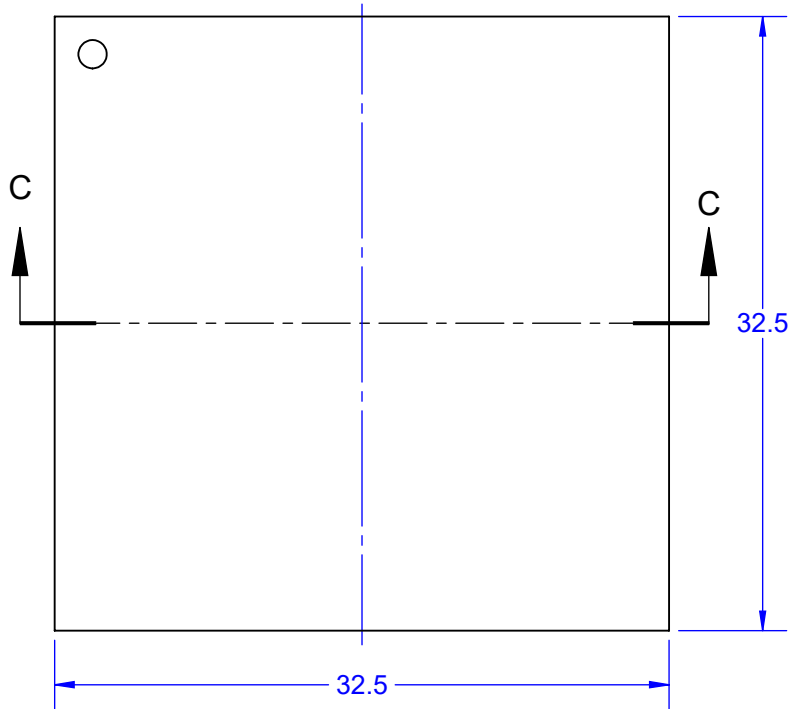

SECTION C-C
SCALE 2.5 : 1

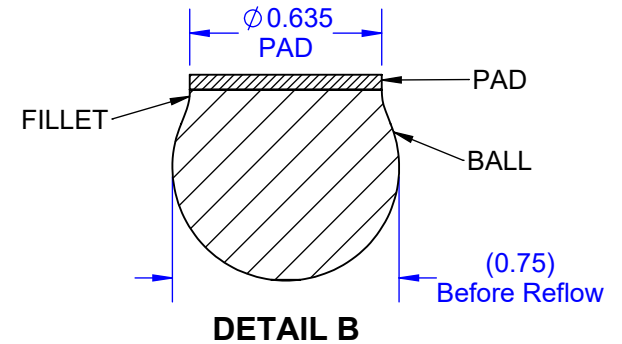

Notes: (Unless Otherwise Specified).

- 1) ALL DIMENSIONS ARE MM.
- 2) SOLDER BALL ALLOY: SEE PART NUMBER CONFIGURATION.
- 3) BALL DIAMETER (BEFORE REFLOW): 0.76mm (30 MIL).
- 4) SOLDER MASK OPENING: 0.635mm (25 MIL).
- 5) SUBSTRATE: ALUMINA CERAMIC.

APPROVALS	DATE	TopLine [®]			
DRAWN T. Au	08/08/2022				
ENG M. Hart	08/08/2022	TITLE CBGA625T1.27C-DC81 CERAMIC BALL GRID ARRAY			
MFG		SCALE	SIZE	DRAWING NO.	REV
QA		2.5:1	A	520817	A
CUST		DO NOT SCALE DRAWING			SHEET 2 OF 6
REVISED					

BALL VIEW

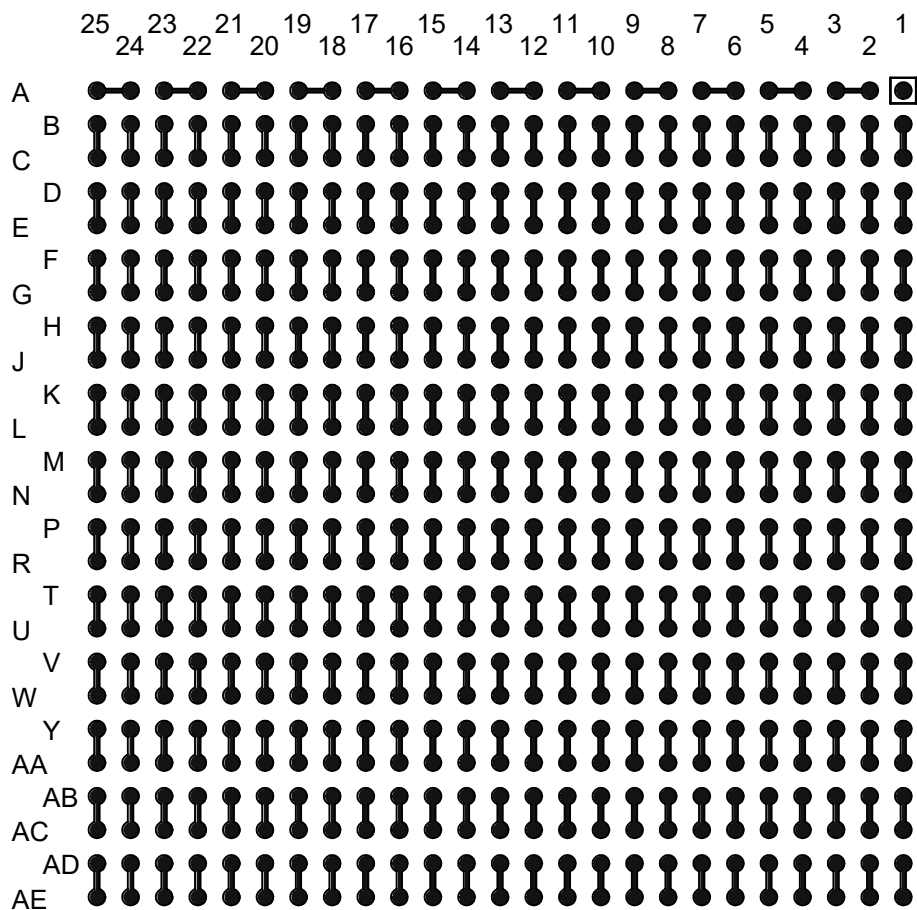

BOTTOM SIDE (TOP X-RAY VIEW)

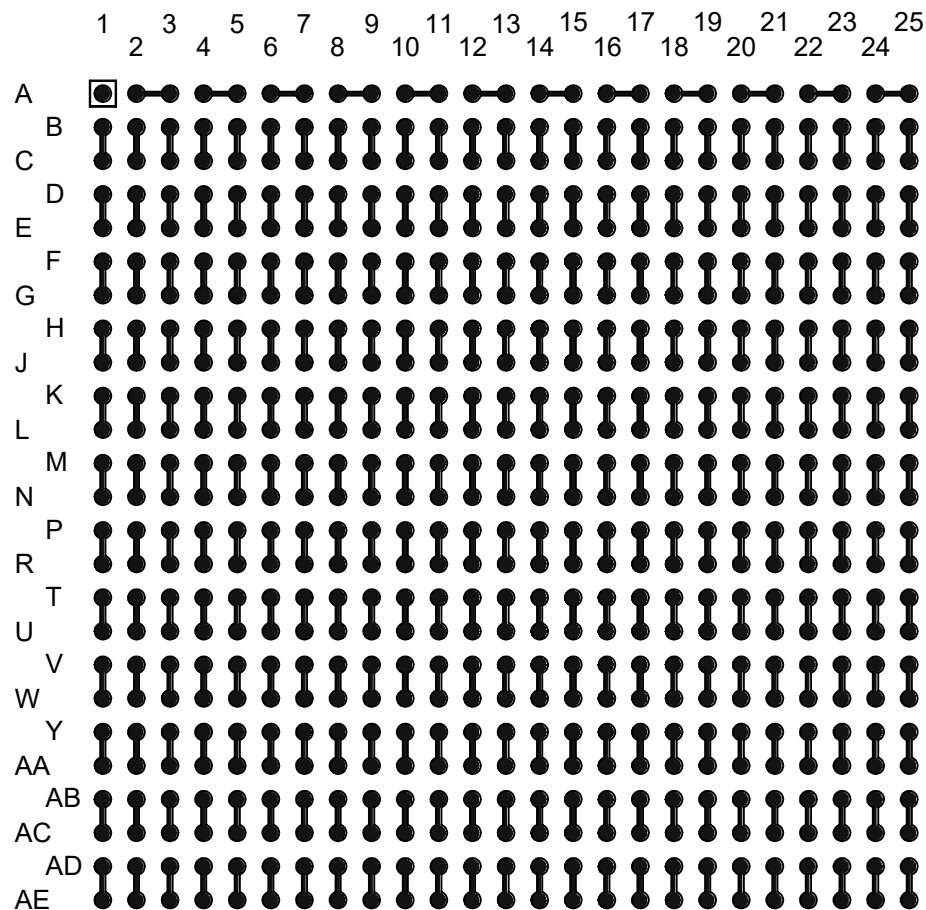

TopLine[®]			
TITLE CBGA625T1.27C-DC81 CERAMIC BALL GRID ARRAY			
SCALE	SIZE	DRAWING NO.	REV
3.5:1	A	520817	A
DO NOT SCALE DRAWING			SHEET 3 OF 6

**MODEL
CBGA WITH BALL
WITHOUT DIE**

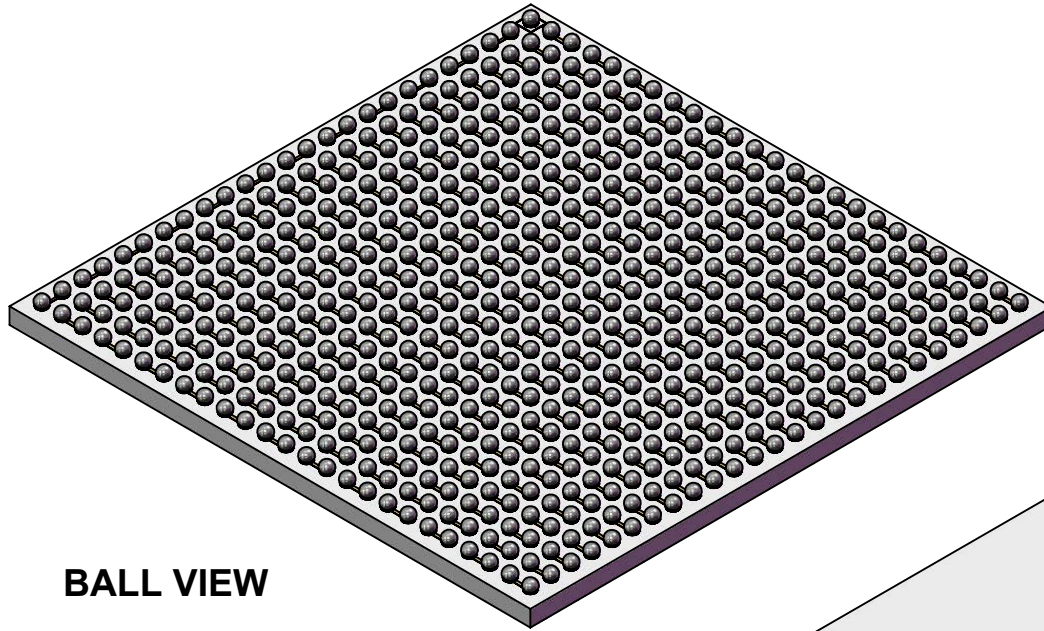

BALL VIEW

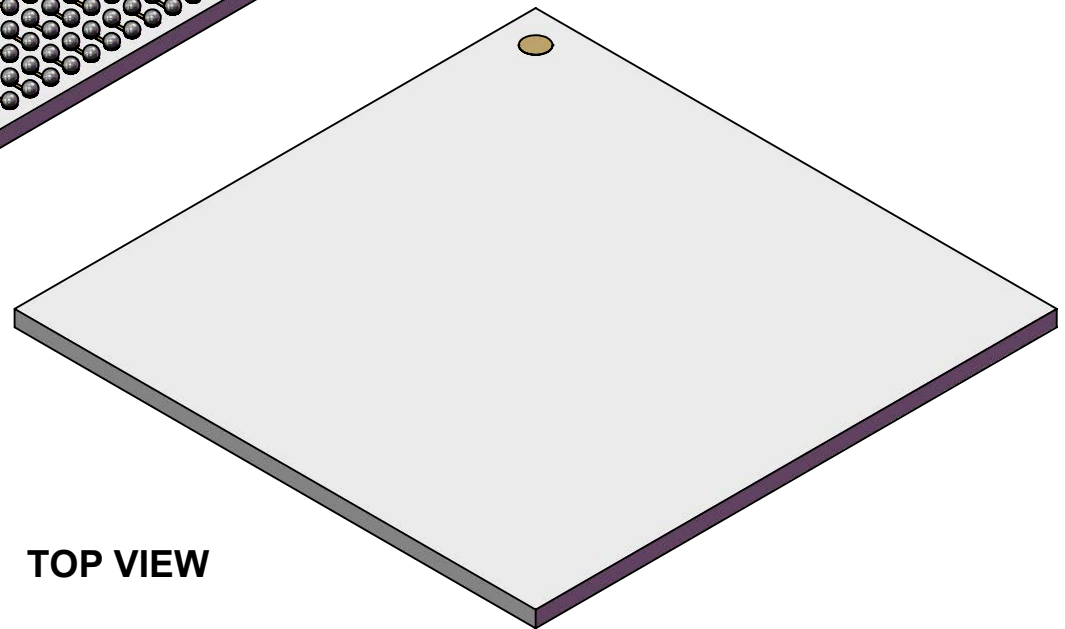

TOP VIEW

TopLine®

TITLE CBGA625T1.27C-DC81
 CERAMIC BALL GRID ARRAY

SCALE	SIZE	DRAWING NO.	REV
3:1	A	520817	A

DO NOT SCALE DRAWING

SHEET 4 OF 6

**MODEL
CBGA WITH BALL
WITH DIE**

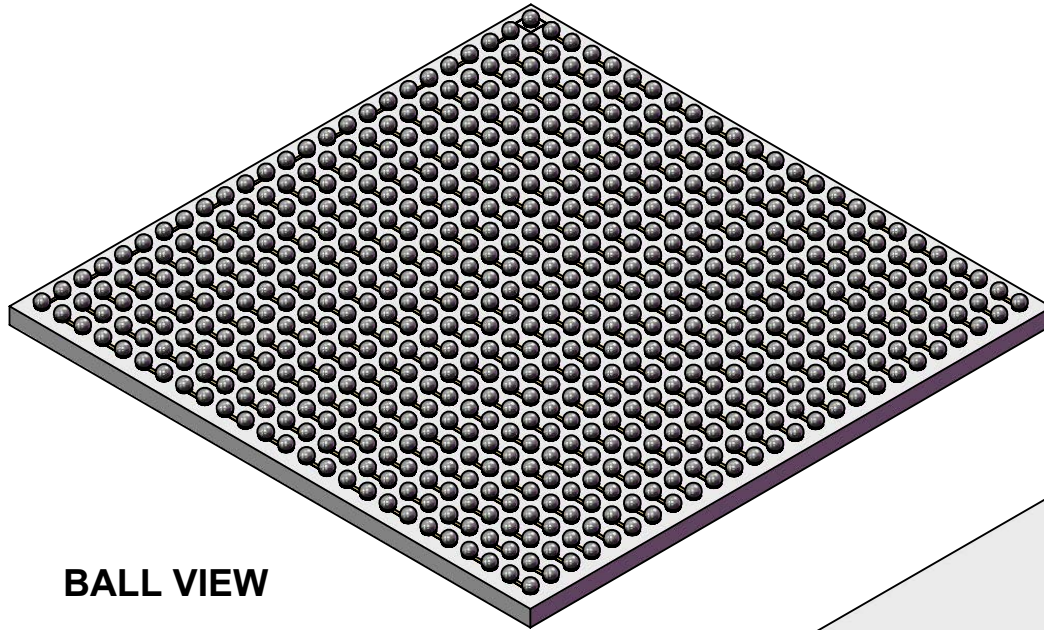

BALL VIEW

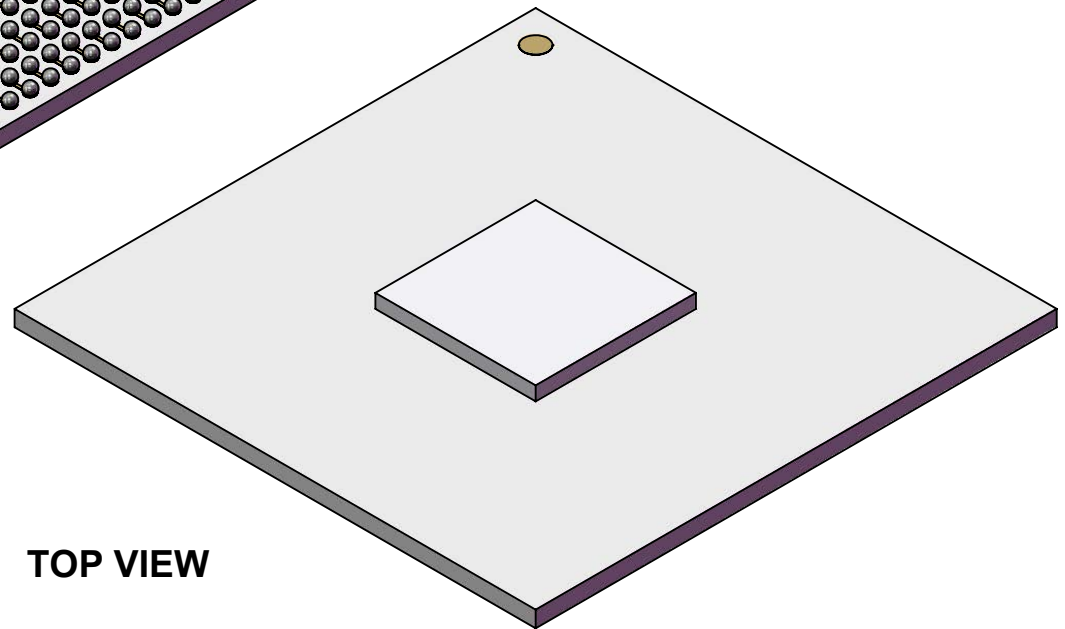

TOP VIEW

TopLine®

TITLE CBGA625T1.27C-DC81
 CERAMIC BALL GRID ARRAY

SCALE	SIZE	DRAWING NO.	REV
3:1	A	520817	A

DO NOT SCALE DRAWING

SHEET 5 OF 6

PART NUMBER SYSTEM

CBGA

625

T

1.27

C

- DC81

D

SERIES

CBGA = CERAMIC
BALL GRID ARRAY

BALLS

NBR SOLDER
BALLS

TRAY

T = JEDEC

PITCH

1.27mm = 0.050"

ALLOY

L = Sn62/Pb36/Ag2.0*
X = Sn63/Pb37*
C = SAC305*
Blank = Sn10/Pb90*

DIE

D = DUMMY DIE
BLANK = WITHOUT DIE

DAISY CHAIN

DC81 = SEE PATTERN

PART NUMBER	BALL ALLOY	CODE	LEAD FREE	DIE
CBGA625T1.27-DC81	Sn10/Pb90*	Sn10	NO	NO
CBGA625T1.27-DC81D	Sn10/Pb90*	Sn10	NO	YES
CBGA625T1.27L-DC81	Sn62/Pb36/Ag2.0*	Sn62	NO	NO
CBGA625T1.27L-DC81D	Sn62/Pb36/Ag2.0*	Sn62	NO	YES
CBGA625T1.27X-DC81	Sn63/Pb37*	Sn63	NO	NO
CBGA625T1.27X-DC81D	Sn63/Pb37*	Sn63	NO	YES
CBGA625T1.27C-DC81	Sn96.5/Ag3.0/Cu0.5*	SAC305	YES	NO
CBGA625T1.27C-DC81D	Sn96.5/Ag3.0/Cu0.5*	SAC305	YES	YES

* THESE BALL ALLOYS ARE NOT RECOMMENDED FOR MOUNTING ON FR4 BOARDS DUE TO CTE MISMATCH

TopLine[®]

TITLE CBGA625T1.27C-DC81
CERAMIC BALL GRID ARRAY

SCALE NONE	SIZE A	DRAWING NO. 520817	REV A
---------------	-----------	-----------------------	----------

DO NOT SCALE DRAWING

SHEET 6 OF 6