

**EXTERIOR VIEW**

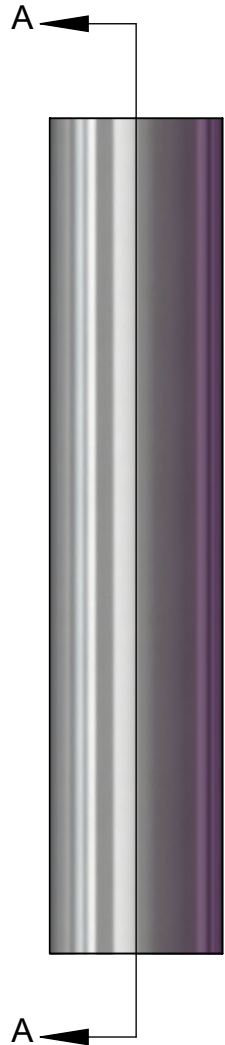

**SECTION VIEW**

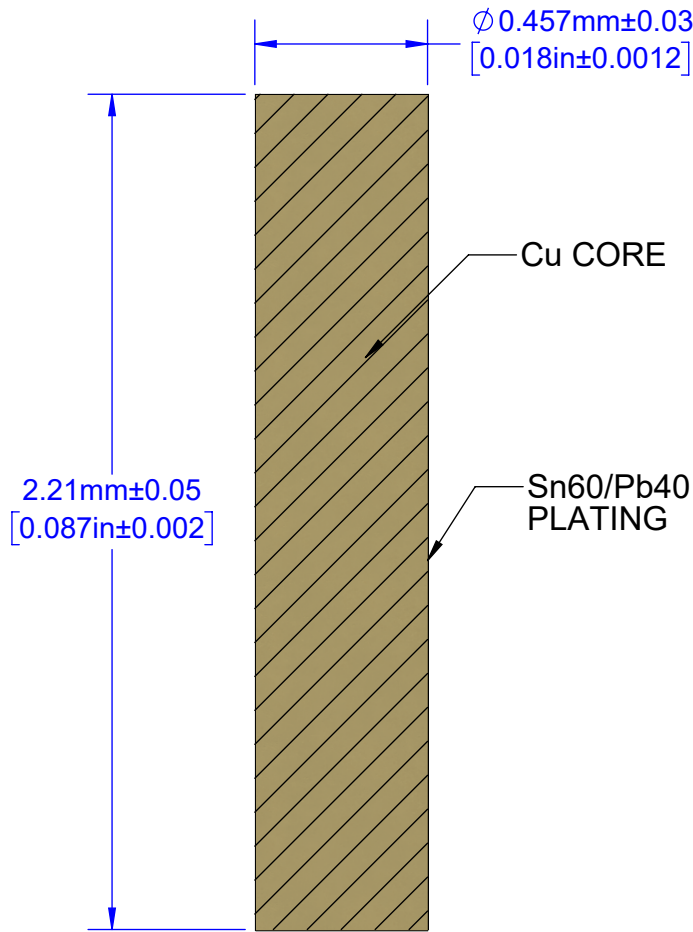

**CCGA - LAND PAD**

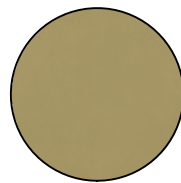
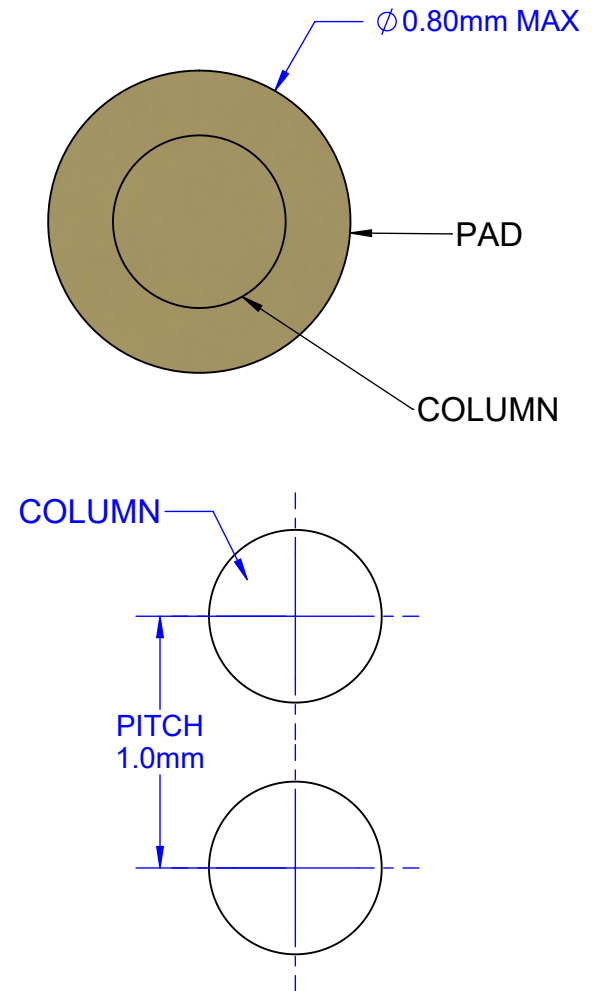

**END VIEW**

Notes: (Unless Otherwise Specified).

- 1) DIMENSIONS IN mm [INCHES].
- 2) MATERIAL: Cu COPPER ALLOY CDA101 OFE-OFHC.
- 3) PLATING: Sn60/Pb40 3.0~5.0 $\mu\text{m}$  [100~200 MICRO-INCH].
- 4) WIRE GAUGE: AWG25.

APPROVALS	DATE	<b>TopLine®</b>			
DRAWN T. Au	01/13/18				
ENG M. Hart	01/13/18	TITLE CU101P18x87 CCGA COPPER COLUMN			
MFG		SCALE	SIZE	DRAWING NO.	REV
QA		50:1	A	301887	A
CUST		DO NOT SCALE DRAWING			SHEET 1 OF 1
REVISED					