

**DETAIL A
SCALE 30 : 1**

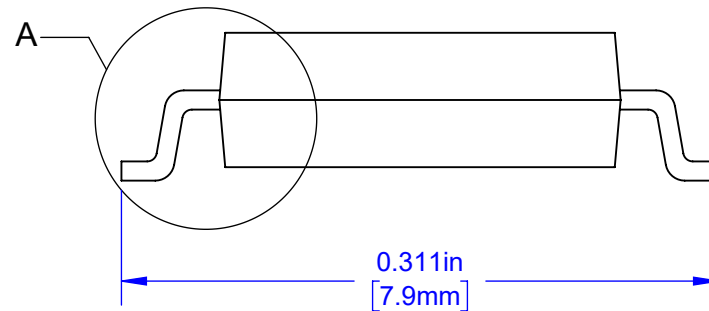
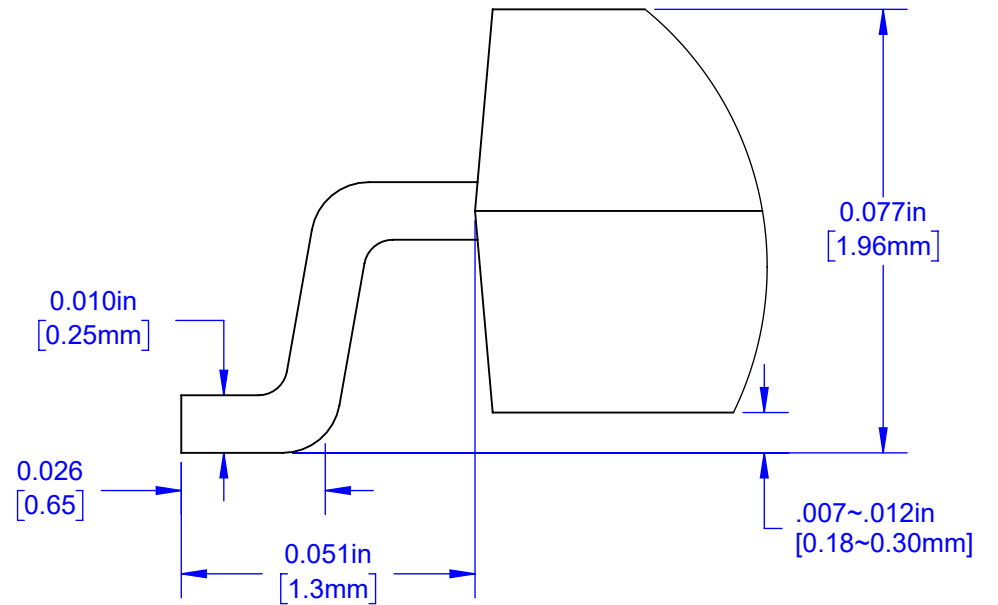

Notes: (Unless Otherwise Specified)

- 1) DIMENSION IN INCH (mm).
- 2) SEE DAISY CHAIN AND JUMPER DIAGRAM (PAGE 2).
- 3) SEE PART NUMBER CONFIGURATION (PAGE 3).
- 4) RECOMMENDED PC BOARD LAYOUT PATTERN (PAGE 5).

APPROVALS	DATE	TopLine®			
DRAWN T. Au	6/27/2024				
ENG M. Hart	6/27/2024	TITLE SOP8 (8-PIN)			
MFG		5.3mm (209 MIL) PACKAGE			
QA		SCALE	SIZE	DRAWING NO.	REV
CUST		10:1	A	120812	A
REVISED		DO NOT SCALE DRAWING			SHEET 1 OF 6

INTERNAL WIRING CIRCUIT (JUMPER) DAISY CHAIN PART NUMBER SUFFIX TOP VIEW

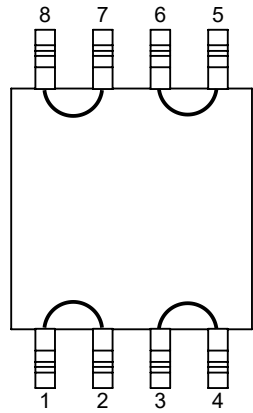

DE
DAISY CHAIN EVEN

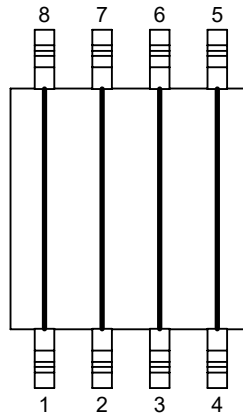

DC28
JUMPER

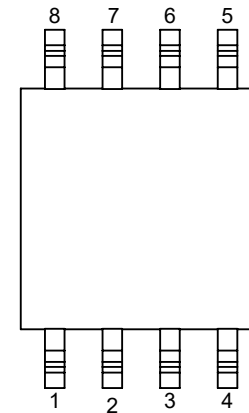

ISO
ISOLATED CIRCUIT
NO INTERNAL
CONNECTIONS

MODEL

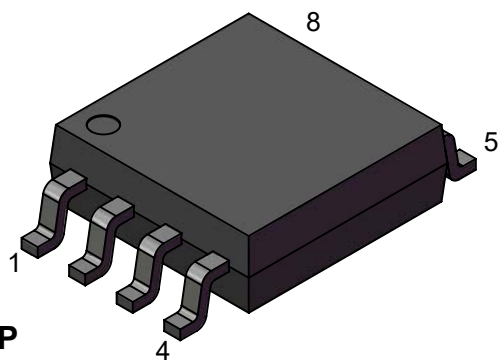

TOP

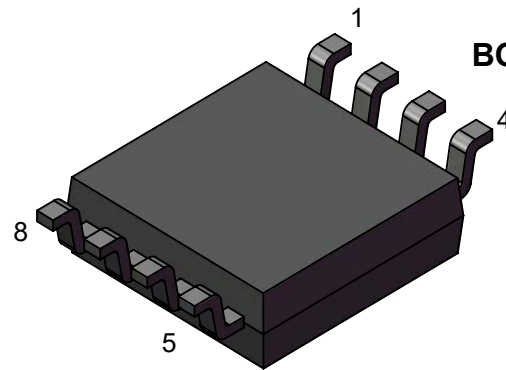

BOTTOM

TopLine®			
TITLE SOP8 (8-PIN) 5.3mm (209 MIL) PACKAGE			
SCALE	SIZE	DRAWING NO.	REV
8:1	A	120812	A
DO NOT SCALE DRAWING			SHEET 2 OF 6

PART NUMBERING SYSTEM

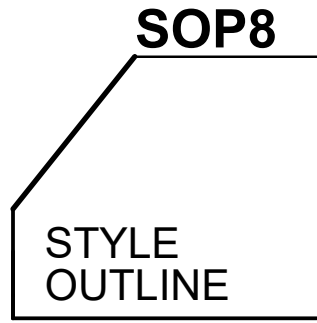

SOP8 = 8 PIN
209mil (5.2mm)

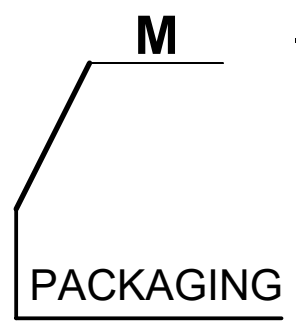

E13A = REEL 13-INCH
E7A = REEL 7-INCH
E = CUT TAPE
M = TUBE

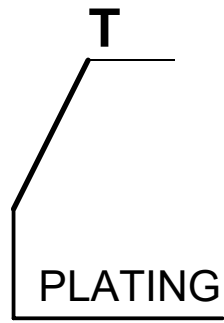

T =
Pb-FREE
RoHS
LEAD FREE

Sn100
MATTE TIN

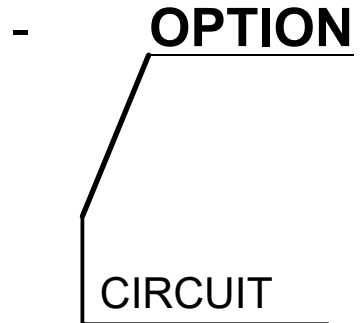

DC28 - JUMPER
DE = DAISY CHAIN
ISO = ISOLATED CIRCUIT
BLANK = DUMMY

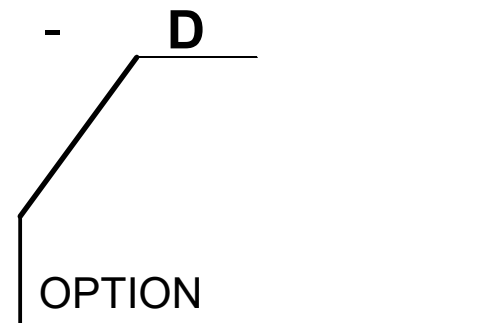

BLANK - COMMERCIAL GRADE

D = INTERNAL DUMMY DIE

PART NUMBER	SHORTED PINS	NOTES	RoHS Pb-FREE	MSL LEVEL
SOP8M-T-DE-D	1-2, 3-4, 5-6, 7-8	TUBES	YES	3
SOP8E13A-T-DE-D	1-2, 3-4, 5-6, 7-8	REEL	YES	3
SOP8E13A-T-DC28	1~8, 2~7, 3~6, 4~5	REEL	YES	3
SOP8E13A-T	DUMMY	REEL	YES	3
SOP8M-T	DUMMY	TUBES	YES	3
SO8M-T-ISO	FULLY ISOLATED	TUBES	YES	3

TopLine®			
TITLE SOP8 (8-PIN) 5.3mm (209 MIL) PACKAGE			
SCALE NONE	SIZE A	DRAWING NO. 120812	REV A
DO NOT SCALE DRAWING			SHEET 3 OF 6

TAPE SPECIFICATION SOP8 SURFACE MOUNT DEVICE

TAPE DIMENSIONS

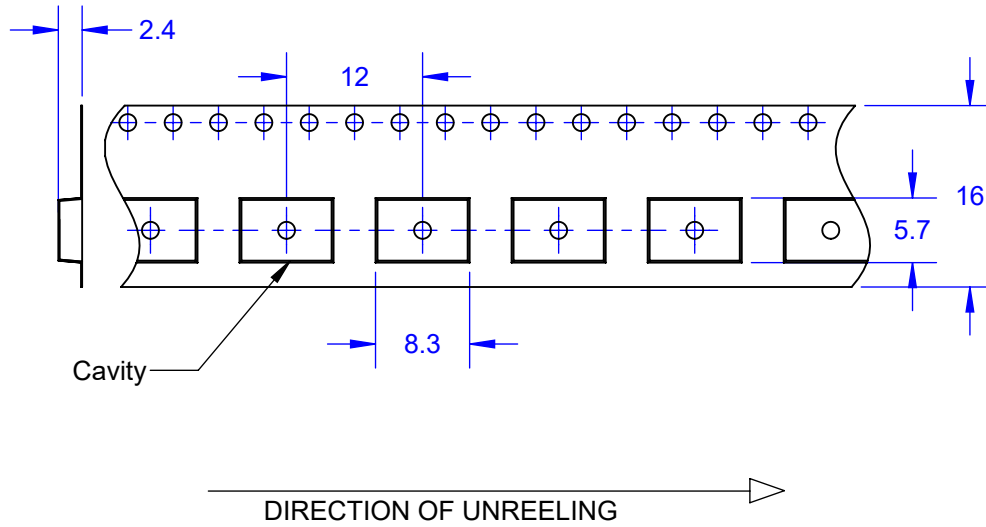

PACKAGE REEL

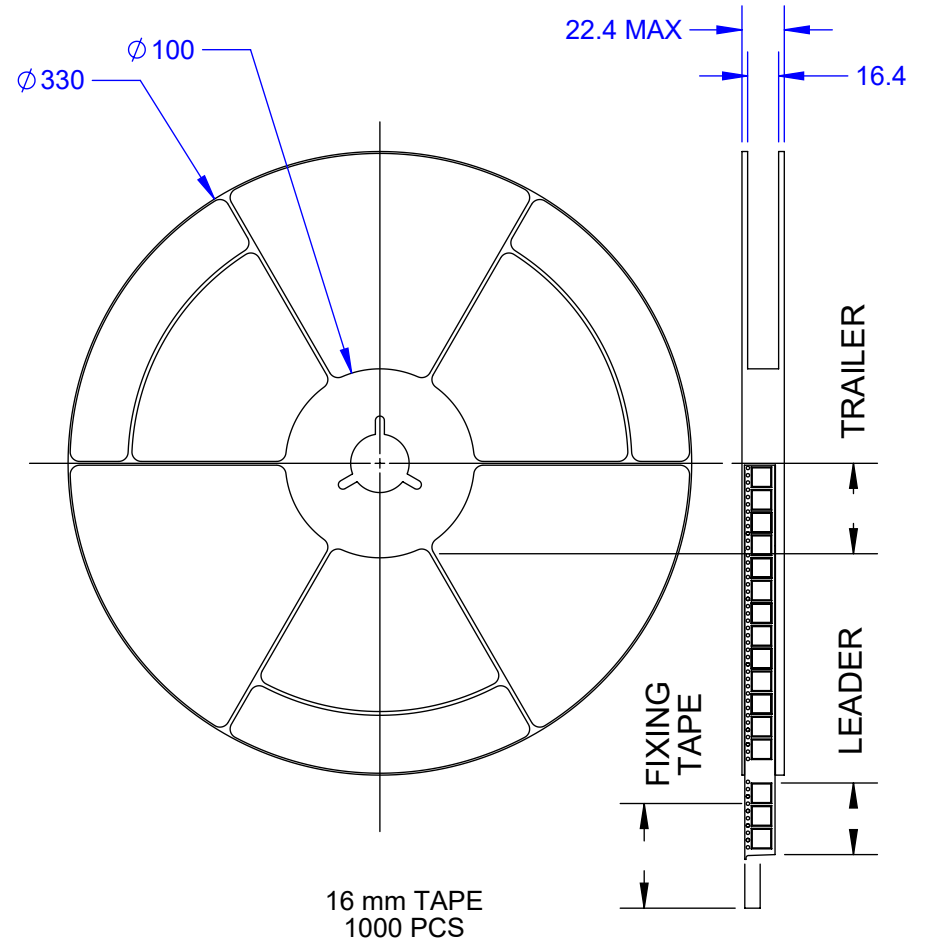

ALL DIMENSIONS IN mm

TopLine[®]			
TITLE		SOP8 (8-PIN) 5.3mm (209 MIL) PACKAGE	
SCALE	SIZE	DRAWING NO.	REV
NONE	A	120812	A
DO NOT SCALE DRAWING			SHEET 4 OF 6

PC BOARD LAND PATTERN

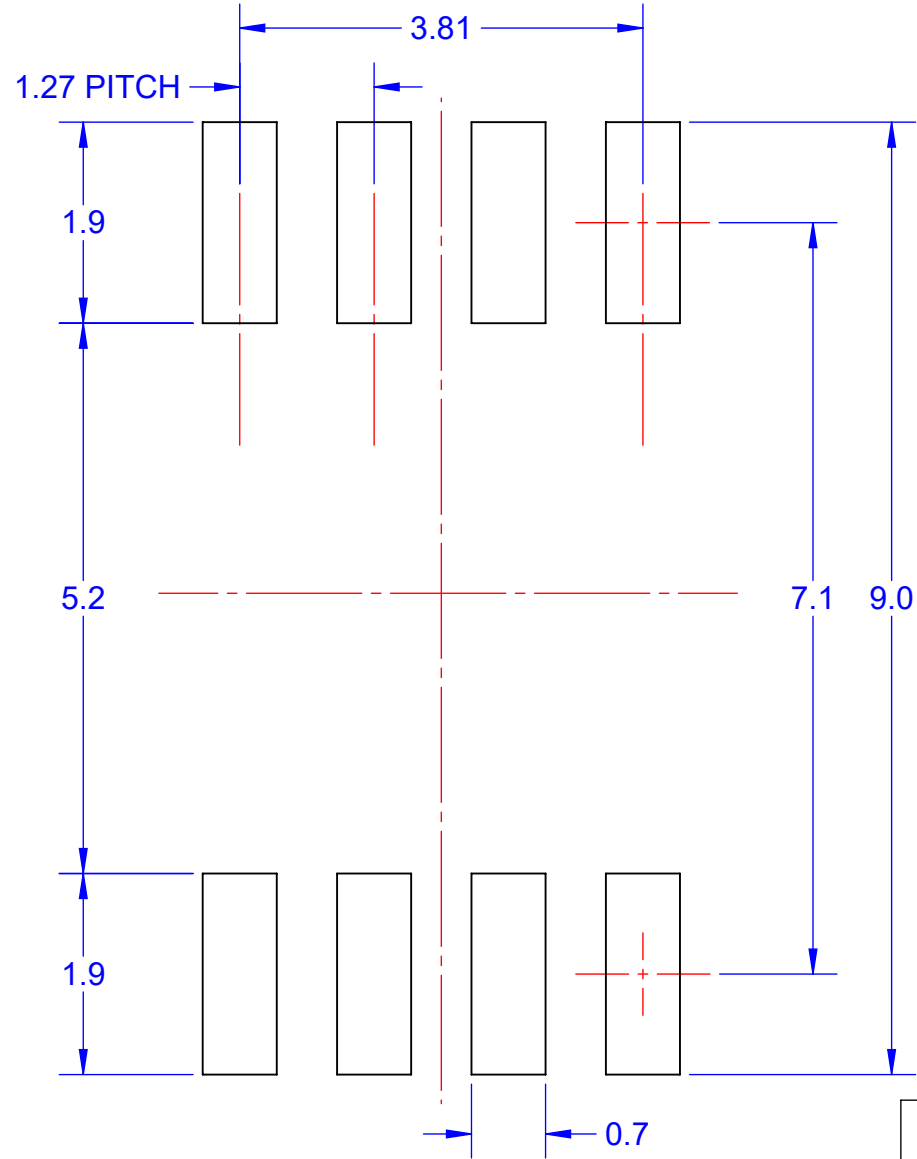

Notes: (Unless Otherwise Specified)

- 1) DIMENSIONS ARE IN INCH (mm).
- 2) PCB BOARD DIMENSIONS ARE PRESENTED ONLY AS A GUIDELINE.
- 3) DESIGNERS SHOULD USE THEIR OWN EXPERIENCE WHEN DESIGNING PCB.

TopLine®

TITLE		SOP8 (8-PIN) 5.3mm (209 MIL) PACKAGE	
SCALE	SIZE	DRAWING NO.	REV
16:1	A	120812	A
DO NOT SCALE DRAWING			SHEET 5 OF 6

LEAD FREE REFLOW PROFILE OF SMD PACKAGE

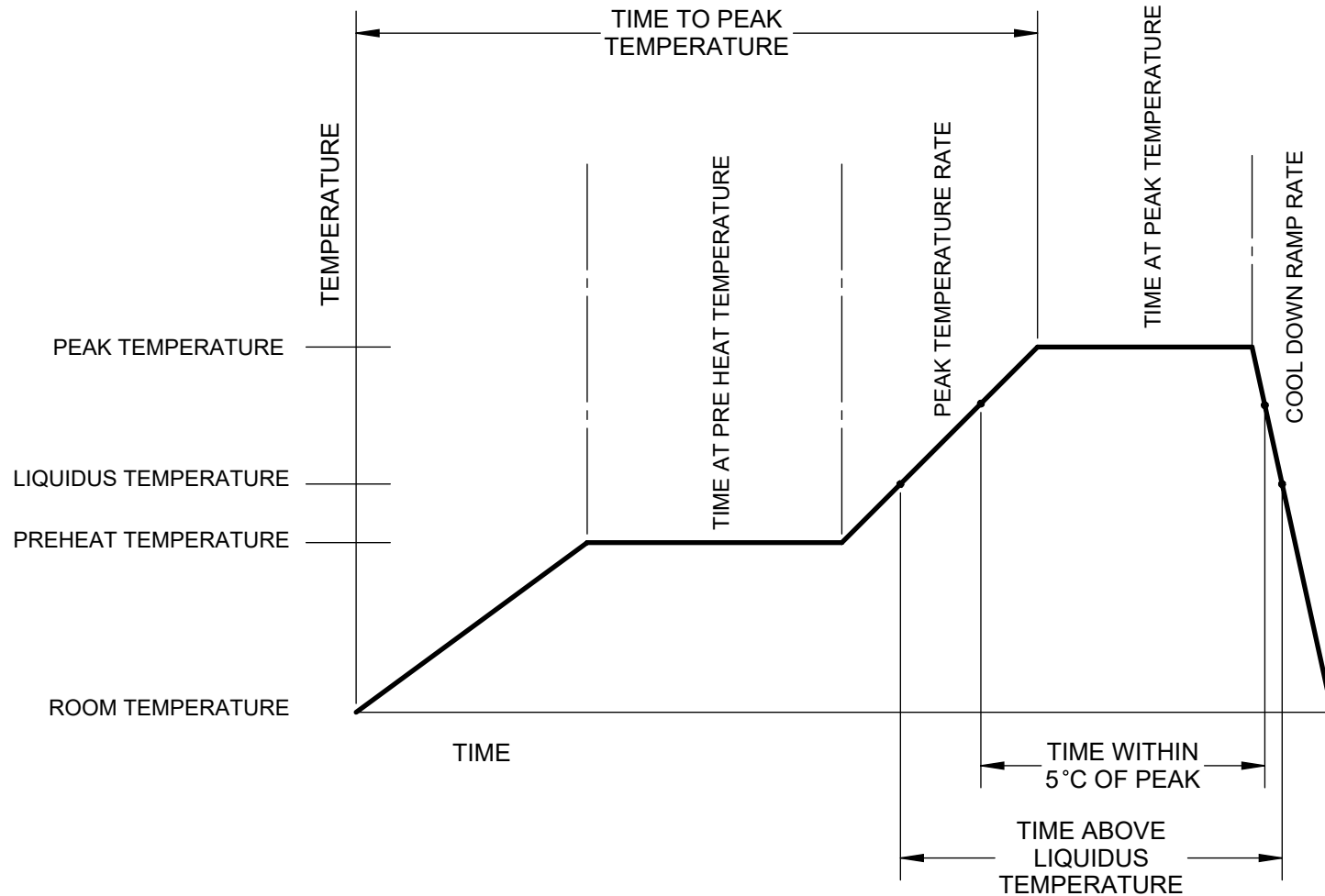

DESCRIPTION	REQUIREMENT
AVERAGE PREHEAT RAMP RATE	3 °C/SECOND MAXIMUM
PREHEAT TEMPERATURE	150 °C MAXIMUM, 200 °C MAXIMUM
PREHEAT TIME	60 TO 80 SECONDS
RAMP TO PEAK	3 °C/SECOND MAXIMUM
TIME OVER LIQUIDUS (217°C)	60 TO 150 SECONDS
PEAK TEMPERATURE	260 °C +0/-5 °C
TIME WITHIN 5°C OF PEAK	20 TO 40 SECONDS
RAMP - COOL DOWN	6 °C/SECONDS MAXIMUM
TIME 25°C TO PEAK	8 MINUTES MAXIMUM

TopLine®			
TITLE		SOP8 (8-PIN) 5.3mm (209 MIL) PACKAGE	
SCALE	SIZE	DRAWING NO.	REV
NONE	A	120812	A
DO NOT SCALE DRAWING			SHEET 6 OF 6