

### SECTION VIEW

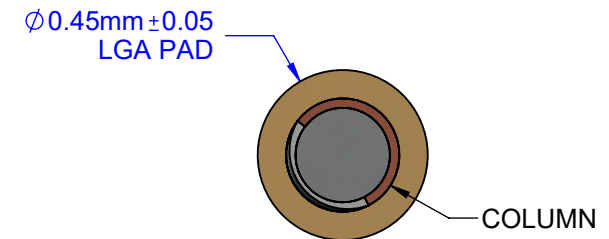
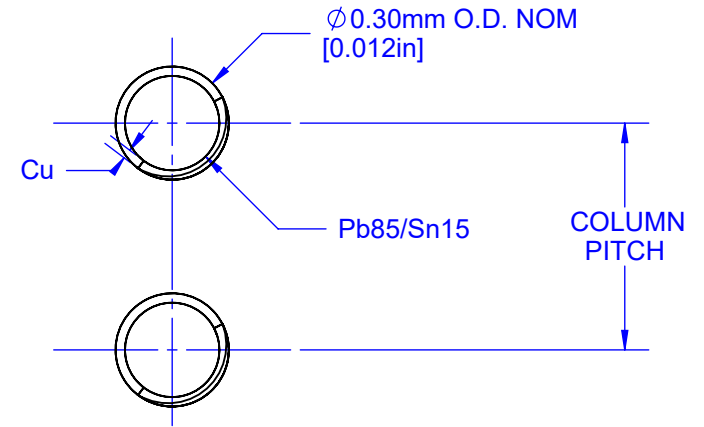
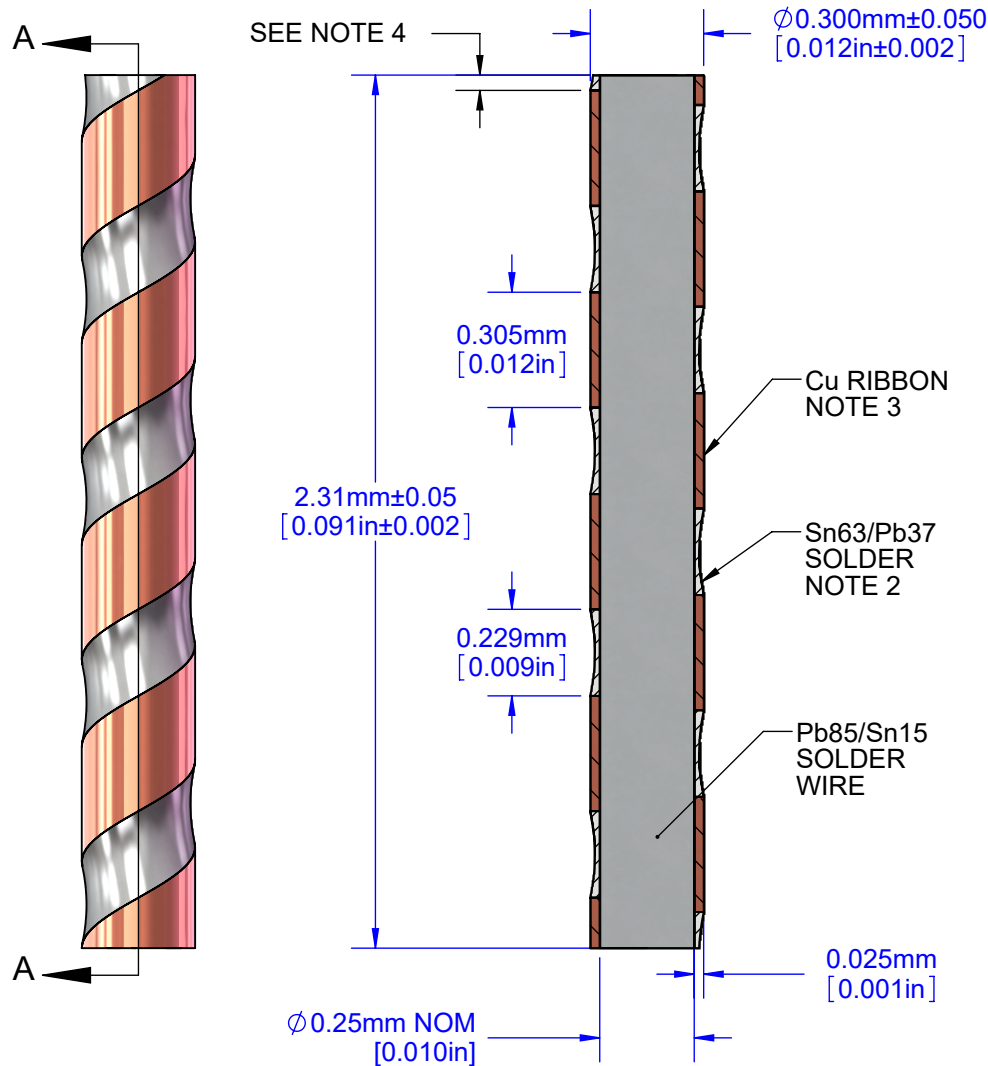

LGA - LAND GRID ARRAY  
PAD PLATING Ni-Au

NOTES: (Unless Otherwise Specified).

- 1) DIMENSIONS IN mm [INCHES].
- 2) THICKNESS Sn63/Pb37 SOLDER COAT  $6 \sim 12\mu\text{m}$  [ $0.25 \sim 0.50\text{mil}$ ].
- 3) Cu ALLOY C10100 - OFE (CDA-101). 99.99% PURE.
- 4) EXPOSED Cu AT BOTH ENDS OF COLUMNS:  $100\mu\text{m}$  TYP.
- 5) ALLOWABLE VOIDS: PER MIL-STD-883J.

APPROVALS	DATE	<b>TopLine®</b>			
DRAWN T. Au	06/03/16				
ENG M. Hart	06/03/16	TITLE CG8515C12x91 CCGA SOLDER COLUMN			
MFG		SCALE	SIZE	DRAWING NO.	REV
QA		40:1	A	851291	A
CUST		DO NOT SCALE DRAWING			SHEET 1 OF 1
REVISED					