

# DAISY CHAIN PATTERN PAD VIEW

## WIRE BONDING PAD DETAIL 1

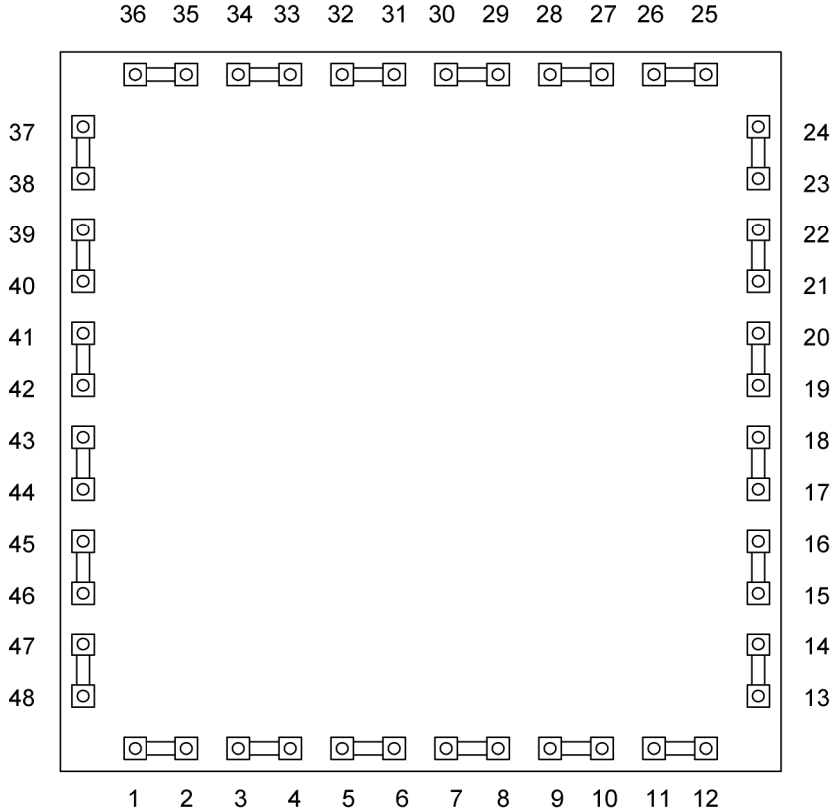
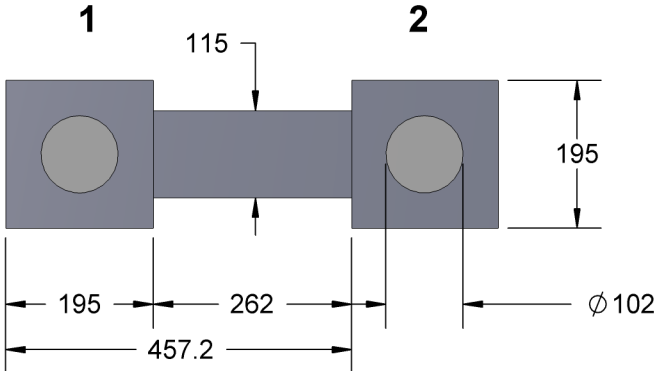

- NOTES:**
- 1) DIMENSIONS IN MICRONS ( $\mu\text{M}$ ) OR AS SPECIFIED.
  - 2) THICKNESS: 635 $\mu\text{m}$  (OTHER AVAILABLE).
  - 3) PASSIVATION: NITRIDE 10KA THICKNESS (1.0 $\mu\text{M}$ ).
  - 4) PACKAGING: STANDARD WAFFLE PACK (TRAY).
  - 5) PAD METAL THICKNESS: 17KA (1.7 $\mu\text{M}$ ).

### PART NUMBER TABLE

PART NUMBER	DIE SIZE	DIE PER WAFER	BOND PAD	DETAIL
FCN48G6.3A457-DC	6.3mm	236	$\phi 102\mu\text{m}$	1

APPROVALS	DATE	<b>TopLine</b> <sup>®</sup>			
DRAWN T. Au	4/20/2018	TITLE FCN48-457 $\mu\text{M}$ PITCH DAISY CHAIN DIE			
ENG M. Hart	4/20/2018				
MFG		SCALE 15:1	SIZE A	DRAWING NO. 691210	REV A
QA					
CUST		DO NOT SCALE DRAWING		SHEET 1 OF 7	
REVISED					

# OUTLINE DIMENSIONS

BACK SIDE

PAD SIDE

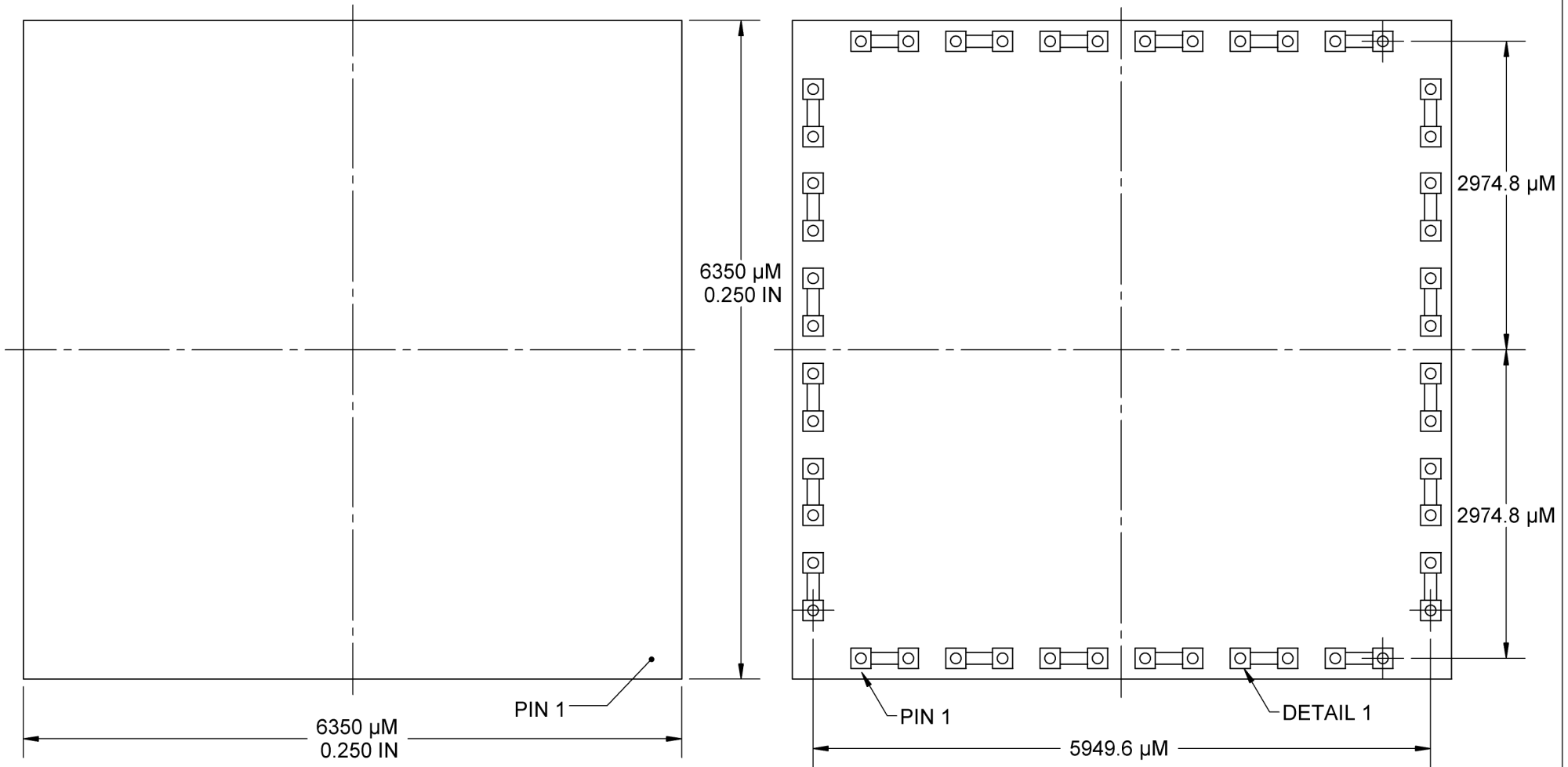

## WIRE BONDING PAD DETAIL 1

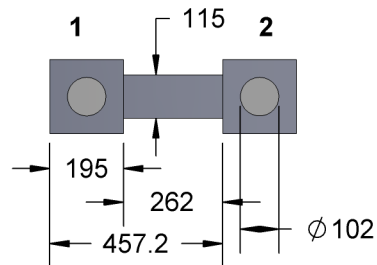

<b>TopLine</b> <sup>®</sup>			
TITLE FCN48-457μM PITCH DAISY CHAIN DIE			
SCALE 17.5:1	SIZE A	DRAWING NO. 691210	REV A
DO NOT SCALE DRAWING			SHEET 2 OF 7

### PAD VIEW

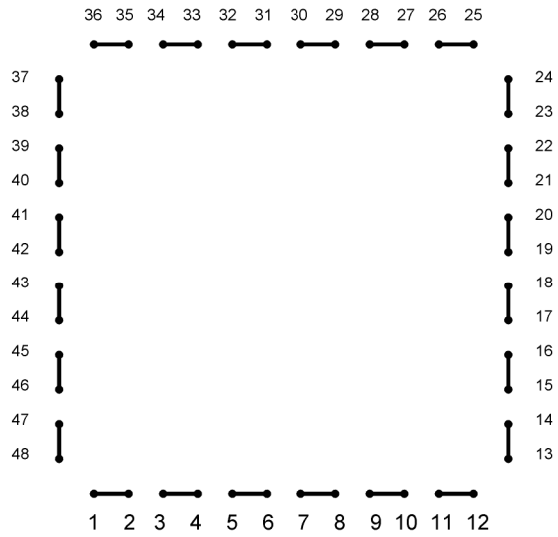

### AFTER BONDING

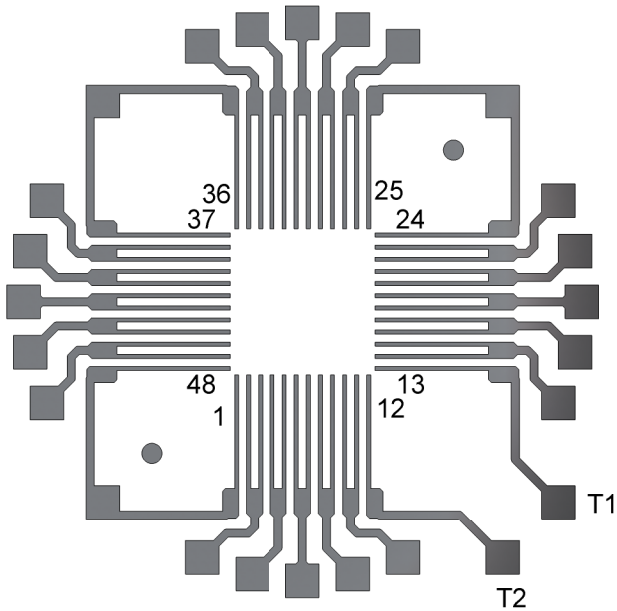
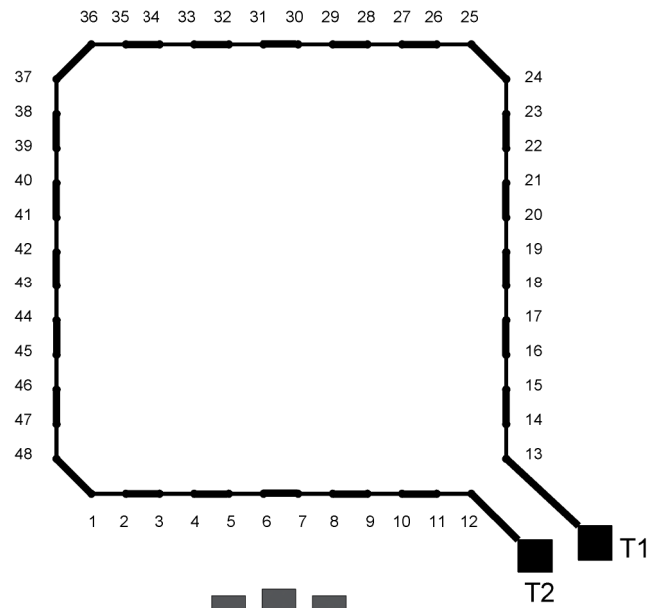

**PCB VIEW**  
SCALE: 3.5/1

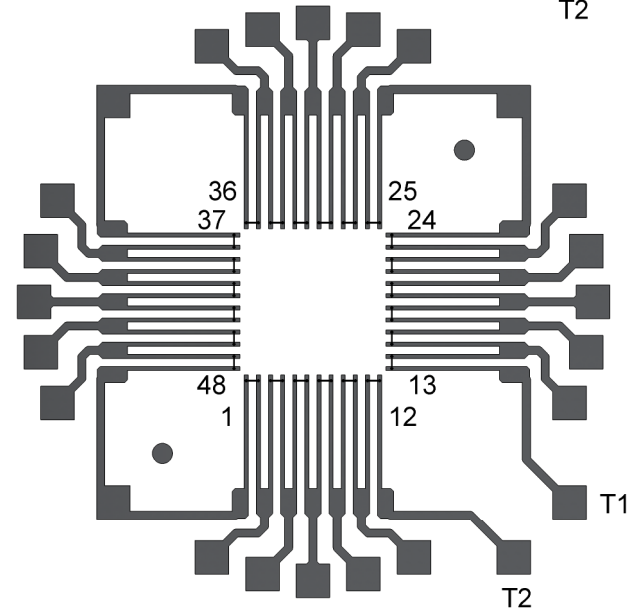

**AFTER BONDING**  
SCALE: 3.5/1

<b>TopLine</b> <sup>®</sup>			
TITLE		FCN48-457uM PITCH DAISY CHAIN DIE	
SCALE	SIZE	DRAWING NO.	REV
10:1	A	691210	A
DO NOT SCALE DRAWING			SHEET 3 OF 7

# PAD LOCATION DIMENSION MICRON ( $\mu\text{M}$ )

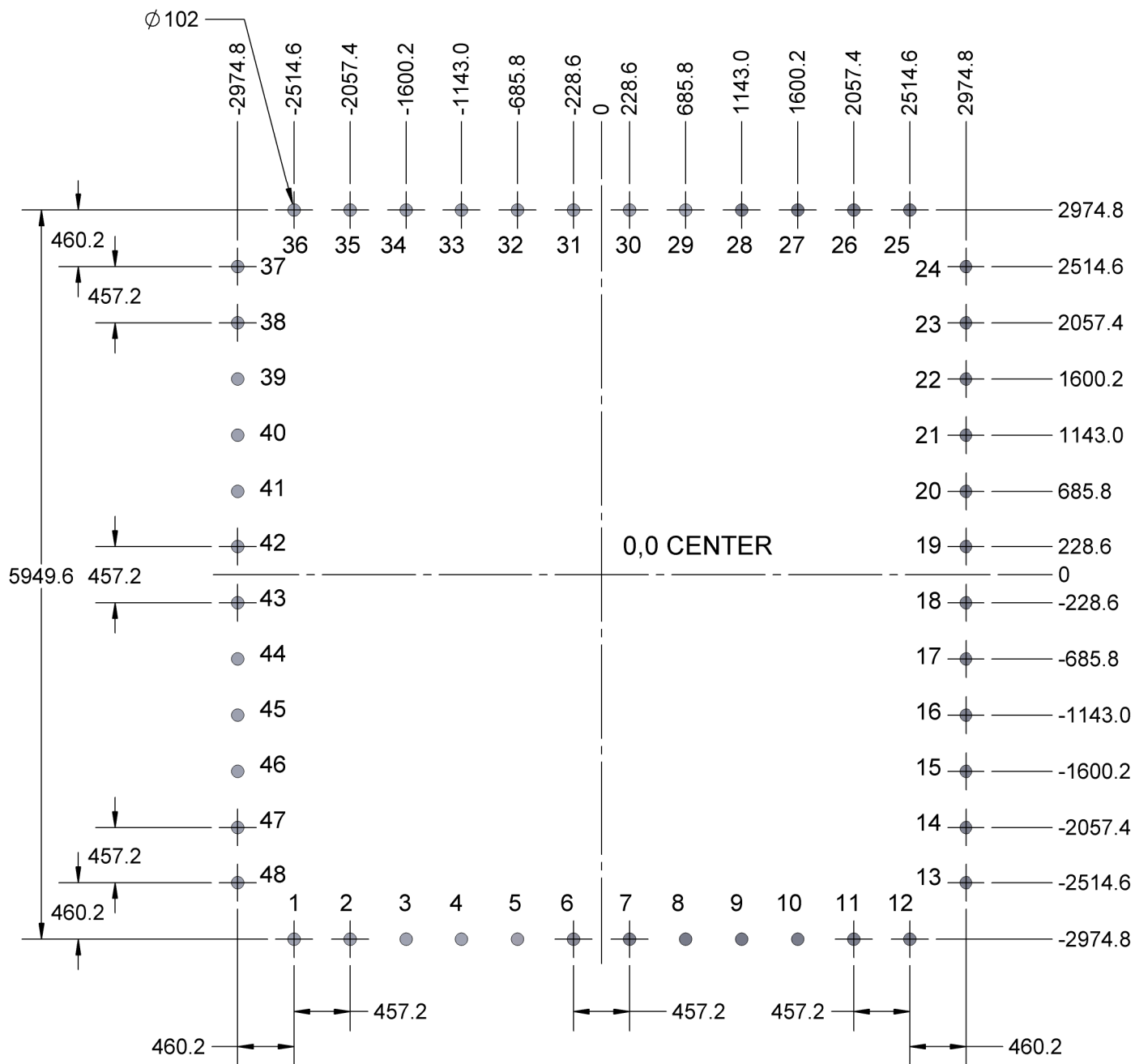

- NOTES:  
 1) DIMENSIONS IN MICRONS ( $\mu\text{M}$ ).  
 2) X=0, Y=0 IS CENTER OF DIE.  
 3) SEE NET LIST PAGE 6.

<b>TopLine</b> ®			
TITLE		FCN48-457 $\mu\text{M}$ PITCH DAISY CHAIN DIE	
SCALE	SIZE	DRAWING NO.	REV
20:1	A	691210	A
DO NOT SCALE DRAWING			SHEET 4 OF 7

# BONDING MAP SEE NET LIST (PAGE 6)

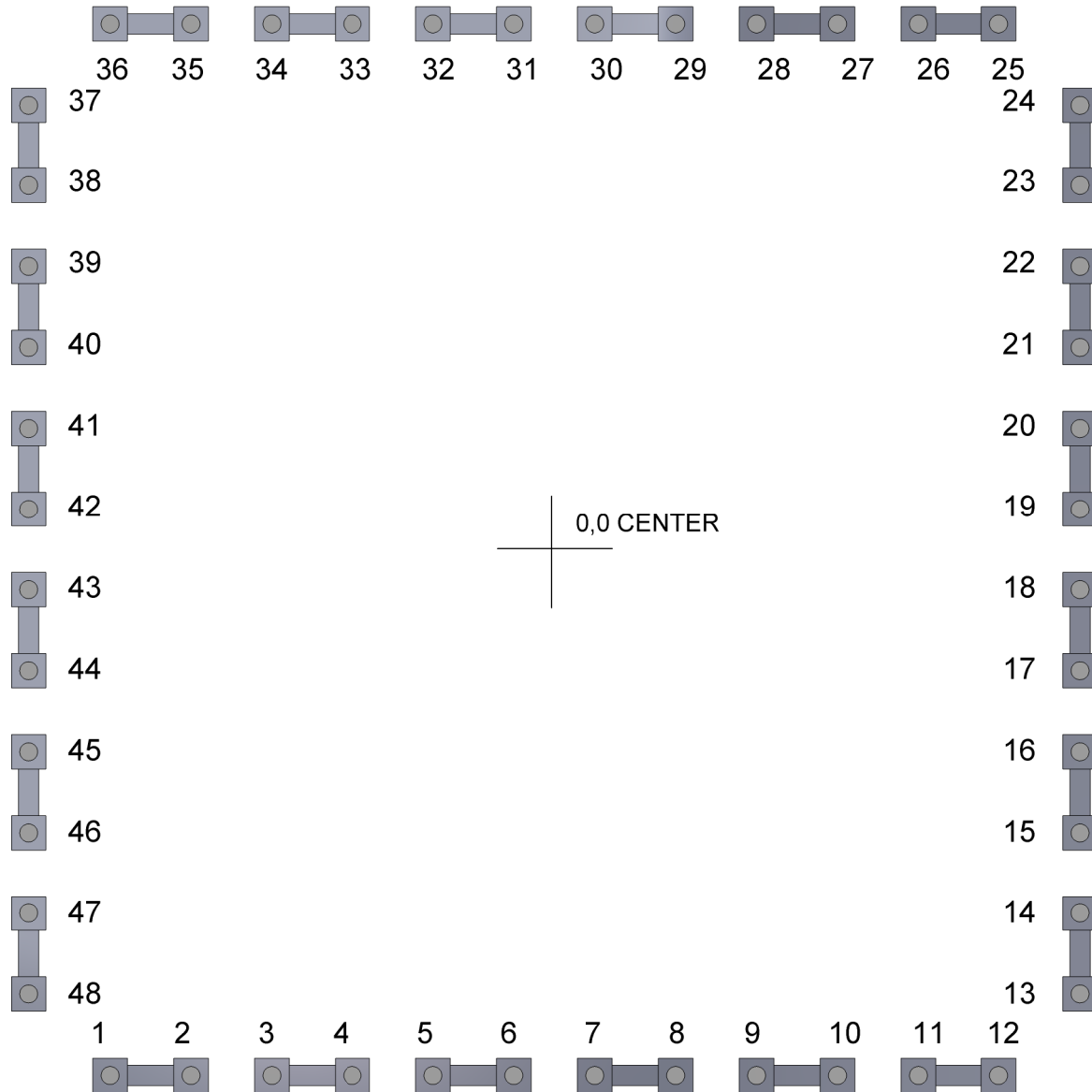

<b>TopLine</b> <sup>®</sup>			
TITLE		FCN48-457uM PITCH DAISY CHAIN DIE	
SCALE	SIZE	DRAWING NO.	REV
25:1	A	691210	A
DO NOT SCALE DRAWING			SHEET 5 OF 7

**FCN48 NET LIST**  
**MICRON ( $\mu\text{M}$ )**  
**(0,0) LOCATED AT THE CENTER OF THE DIE**

PIN#	X	Y
1	-2514.6	-2974.8
2	-2057.4	-2974.8
3	-1600.2	-2974.8
4	-1143	-2974.8
5	-685.8	-2974.8
6	-228.6	-2974.8
7	228.6	-2974.8
8	685.8	-2974.8
9	1143	-2974.8
10	1600.2	-2974.8
11	2057.4	-2974.8
12	2514.6	-2974.8
13	2974.8	-2514.6
14	2974.8	-2057.4
15	2974.8	-1600.2
16	2974.8	-1143
17	2974.8	-685.8
18	2974.8	-228.6
19	2974.8	228.6
20	2974.8	685.8
21	2974.8	1143
22	2974.8	1600.2
23	2974.8	2057.4
24	2974.8	2514.6

PIN#	X	Y
25	2514.6	2974.8
26	2057.4	2974.8
27	1600.2	2974.8
28	1143	2974.8
29	685.8	2974.8
30	228.6	2974.8
31	-228.6	2974.8
32	-685.8	2974.8
33	-1143	2974.8
34	-1600.2	2974.8
35	-2057.4	2974.8
36	-2514.6	2974.8
37	-2974.8	2514.6
38	-2974.8	2057.4
39	-2974.8	1600.2
40	-2974.8	1143
41	-2974.8	685.8
42	-2974.8	228.6
43	-2974.8	-228.6
44	-2974.8	-685.8
45	-2974.8	-1143
46	-2974.8	-1600.2
47	-2974.8	-2057.4
48	-2974.8	-2514.6

**NOTES:**

- 1) DIMENSIONS IN MICRON ( $\mu\text{M}$ ).
- 2) X = 0, Y = 0 IS CENTER OF DIE.

<b>TopLine</b> <sup>®</sup>			
TITLE		FCN48-457 $\mu\text{M}$ PITCH DAISY CHAIN DIE	
SCALE	SIZE	DRAWING NO.	REV
10:1	A	691210	A
DO NOT SCALE DRAWING			SHEET 6 OF 7

# PART NUMBERING SYSTEM

**FCN**

**48**

**G**

**6.3**

**A**

**457**

**- OPTION**

**- DC**

**- PACKING**

## BONDING DIE

FCN = SINGLE DIE  
 FCWN = UNSAWN WAFER  
 5-INCH (125mm)

## NBR BOND PADS

PADS	DIE ARRAY	SIZE
48	1X	6.3MM
96	4X	12.7MM
144	9X	19MM
192	16X	25.4MM

## PAD OPENNING

∅ 102μM

## DIE SIZE

CODE	MM	MIL
6.3	6.35MM	250
12.7	12.7MM	500
19	19MM	750
25	25MM	1000

## PAD MATERIAL

A = Al98, Si1.0 Cu1.0

## BUMP PITCH

μM

## OPTIONS

### DIE THINNING

CODE	μM	INCH
NONE	635μM	.025"
BG530	530μM	.021"
BG430	430μM	.017"
BG360	360μM	.014"
BG250	250μM	.010"
BG200	200μM	.008"
BG150	150μM	.006"
BG100	100μM	.004"

OTHER THICKNESS AVAILABLE

## DAISY CHAIN

## PACKAGING

BLANK = TRAY (STANDARD)

SIZE	TRAY	QTY
6.3MM	2-INCH	25PCS
12.7MM	4-INCH	36PCS
19MM	4-INCH	16PCS
25MM	4-INCH	9PCS

**TopLine**®

TITLE FCN48-457μM PITCH  
 DAISY CHAIN DIE

SCALE	SIZE	DRAWING NO.	REV
10:1	A	691210	A

DO NOT SCALE DRAWING

SHEET 7 OF 7